

**GENERAL NOTES :**

1) THE ANCHORAGE METHODS SHOWN HAVE BEEN DESIGNED TO COMPLY WITH THE FLORIDA BUILDING CODE 2007 EDITION FOR THE DESIGN PRESSURES LISTED IN THE APPLICABLE PRODUCT TEST REPORTS. THE 1/3 STRESS INCREASE WAS NOT USED IN THIS ANCHOR EVALUATION. THE 1.6 LOAD DURATION FACTOR WAS USED FOR THE EVALUATION OF WOOD SCREWS

2) MATERIALS USED FOR ANCHOR EVALUATIONS WERE SOUTHERN PINE AND CONCRETE MASONRY UNITS COMPLYING WITH ASTM C-90.

3) WOOD BUCKS DEPICTED AS 1X ARE LESS THAN 1-1/2" THICK. 1x WOOD BUCKS ARE OPTIONAL IF UNIT IS INSTALLED DIRECTLY TO SOLID CONCRETE. WOOD BUCKS DEPICTED AS 2X ARE 1-1/2" THICK OR GREATER. ATTACHMENT METHOD OF WOOD BUCKS SHALL BE DONE BY OTHERS.

4) SHIM EACH ANCHOR LOCATION WHERE THE PRODUCT IS NOT FLUSH TO THE SUBSTRATE, USING SHIMS CAPABLE OF TRANSFERRING THE APPLIED LOADS.

5) ANCHORS SHALL BE COATED OR CORROSION RESISTANT AS APPROPRIATE FOR SUBSTRATE MATERIAL. DISSIMILAR MATERIALS SHALL BE PROTECTED AS REQUIRED TO PREVENT REACTIONS. ALUMINUM SHALL BE PROTECTED FROM DISSIMILAR MATERIALS AS SPECIFIED IN FLORIDA BUILDING CODE CHAPTER 20.

6) ADHESIVE SEALANT SHALL BE USED BETWEEN SUBSTRATE AND FLANGE/FIN. OVERALL SEALING/FLASHING STRATEGY FOR WATER RESISTANCE OF INSTALLATION SHALL BE DONE BY OTHERS.

7)REFERENCE TEST REPORTS: NCTL-210-3636-1A, NCTL-210-3642-1A, AND FTL-6328, 6329, 6333.

8) PRODUCT MAY BE INSTALLED INTO STEEL OR ALUMINUM SIMILAR TO THE WOOD INSTALLATION DETAILS.

9) USE ANCHOR GUIDELINES BELOW:

ANCHOR	SUBSTRATE	MIN. EDGE DISTANCE	MIN. EMBEDMENT
3/16" MASONRY	CONCRETE	1"	1-3/8"
	CMU	1"	1-1/4"
#10 SMS	WOOD	7/8"	1-3/8"
	STL STUD GR33	3/8"	.060" (16 GA)
	ALUM-6063 T5	3/8"	.125"
	STEEL, A36	3/8"	.125"

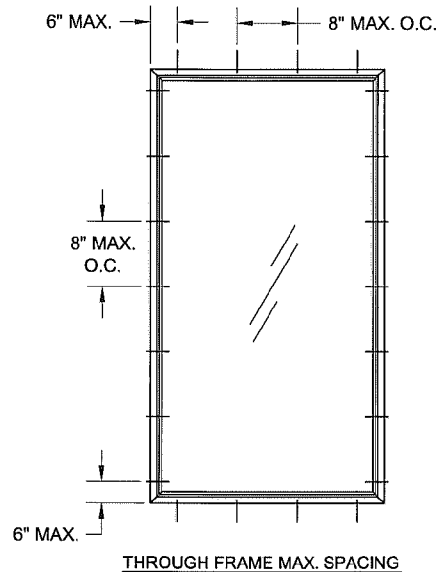

**IMPACT  
RESISTANT**

MAX. SIZE		DP (PSF)		GLASS TYPE	INTERLAYER
WIDTH	HEIGHT	(+)	(-)		
48"	96"	75.0	120.0	7/16" HS LAMI IG WITH 3/16" T CAP	SGP
53"	84"	75.0	120.0	7/16" LAMI IG WITH 3/16" T CAP	SGP
76"	84"	80.0	80.0	7/16" HS LAMI IG WITH (2) 3/16" T CAPS	SGP
77"	85"	65.0	80.0	7/16" HS LAMI IG WITH 3/16" T CAP	SGP

	PGT		Drawn By: J. ROSOWSKI Date: 03/04/11 Material: VINYL		THE INFORMATION, DESIGN OR DATA CONTAINED HEREIN IS THE EXCLUSIVE PROPERTY OF PGT INDUSTRIES AND CONSIDERED CONFIDENTIAL AND PROPRIETARY. NO PORTION OF THIS DOCUMENT MAY BE USED OR REPRODUCED IN ANY FORM WITHOUT THE EXPRESSED WRITTEN PERMISSION OF PGT INDUSTRIES.	
	3070 TECHNOLOGY DRIVE NOKOMIS, FL 34275 FL CERT. OF AUTH.: 29296 A. Lynn Miller, P.E. P.E. #58705		Revisd By: _____ Date: _____ Revisd Date: _____			
			Description: _____			
	<b>PICTURE WINDOW INSTALLATION</b>		Series/Model: PW-2820	Scale: NTS		Sheet: 1 of 2

## MASONRY INSTALLATION

← EXTERIOR

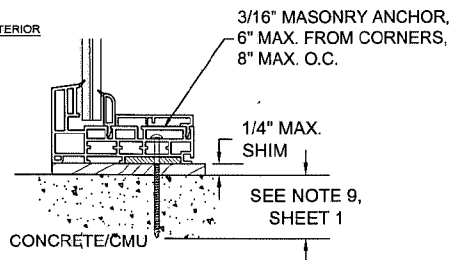

EQUAL-LEG  
MOUNTED DIRECTLY  
TO MASONRY

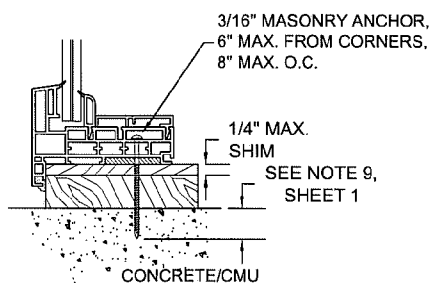

FLANGED  
MOUNTED THROUGH  
1X WOOD BUCK

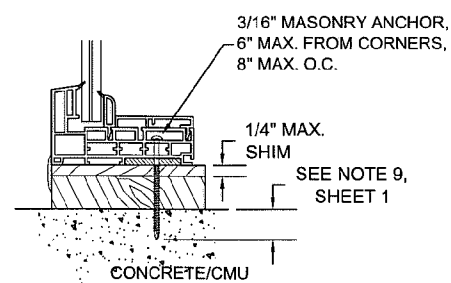

EQUAL-LEG  
MOUNTED THROUGH  
1X WOOD BUCK

## WOOD-FRAME INSTALLATION

← EXTERIOR

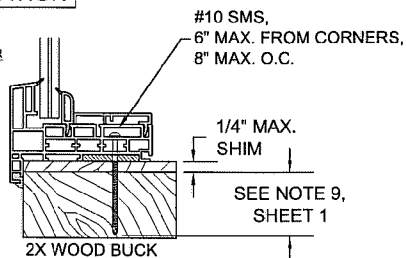

FLANGED  
MOUNTED TO  
2X WOOD BUCK

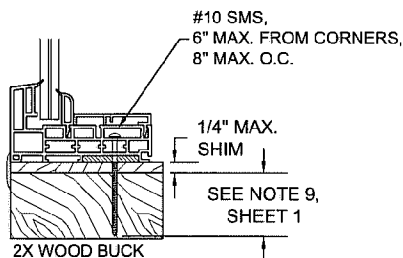

EQUAL-LEG  
MOUNTED TO  
2X WOOD BUCK

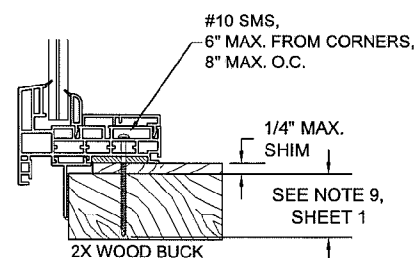

ADDON FIN  
MOUNTED TO  
2X WOOD BUCK

- 1) SEE GENERAL NOTES SHEET 1.
- 2) HEAD SHOWN, JAMBS AND SILL SIMILAR.
- 3) GLASS TYPE SHOWN NOT SPECIFIC, AND MAY BE AN ALTERNATE CONFIGURATION.

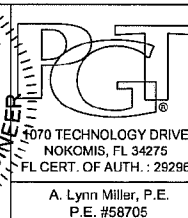
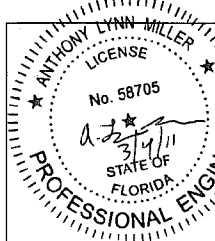

Drawn By: J. ROSOWSKI	Date: 03/04/11	Material: VINYL	THE INFORMATION, DESIGN OR DATA CONTAINED HEREIN IS THE EXCLUSIVE PROPERTY OF PGT INDUSTRIES AND CONSIDERED CONFIDENTIAL AND PROPRIETARY. NO PORTION OF THIS DOCUMENT MAY BE USED OR REPRODUCED IN ANY FORM WITHOUT THE EXPRESSED WRITTEN PERMISSION OF PGT INDUSTRIES.
Revised By:	Date:	Revisions:	
Description:			
Title: <b>PICTURE WINDOW INSTALLATION</b>			
Series/Model: PW-2820	Scale: NTS	Sheet: 2 of 2	Drawing No. 2030411JR
			Rev: