



DEPARTMENT OF REGULATORY AND ECONOMIC RESOURCES (RER)
BOARD AND CODE ADMINISTRATION DIVISION

NOTICE OF ACCEPTANCE (NOA)

MIAMI-DADE COUNTY
PRODUCT CONTROL SECTION

11805 SW 26 Street, Room 208
T (786) 315-2590 F (786) 315-2599

www.miamidade.gov/economy

PGT Industries, Inc.
1070 Technology Drive
North Venice, FL 34275

SCOPE:

This NOA is being issued under the applicable rules and regulations governing the use of construction materials. The documentation submitted has been reviewed and accepted by Miami-Dade County RER - Product Control Section to be used in Miami Dade County and other areas where allowed by the Authority Having Jurisdiction (AHJ).

This NOA shall not be valid after the expiration date stated below. The Miami-Dade County Product Control Section (In Miami-Dade County) and/or the AHJ (in areas other than Miami-Dade County) reserve the right to have this product or material tested for quality assurance purposes. If this product or material fails to perform in the accepted manner, the manufacturer will incur the expense of such testing and the AHJ may immediately revoke, modify, or suspend the use of such product or material within their jurisdiction. RER reserves the right to revoke this acceptance, if it is determined by Miami-Dade County Product Control Section that this product or material fails to meet the requirements of the applicable building code.

This product is approved as described herein, and has been designed to comply with the Florida Building Code, including the High Velocity Hurricane Zone.-

DESCRIPTION: Series "SH-500 Vinyl" White PVC Single Hung Window - L.M.I.

APPROVAL DOCUMENT: Drawing No. 5191-1, titled "Vinyl Single Hung Window, Large Missile Impact", sheets 1 through 11 of 11, dated 08/07/08, with revision D dated 06/01/15, prepared by manufacturer, signed and sealed by Anthony Lynn Miller, P.E., bearing the Miami-Dade County Product Control Section Revision stamp with the Notice of Acceptance number and expiration date by the Miami-Dade County Product Control Section.

MISSILE IMPACT RATING: Large and Small Missile Impact Resistant

LABELING: Each unit shall bear a permanent label with the manufacturer's name or logo, city, state, model/series, and following statement: "Miami-Dade County Product Control Approved", unless otherwise noted herein.

RENEWAL of this NOA shall be considered after a renewal application has been filed and there has been no change in the applicable building code negatively affecting the performance of this product.

TERMINATION of this NOA will occur after the expiration date or if there has been a revision or change in the materials, use, and/or manufacture of the product or process. Misuse of this NOA as an endorsement of any product, for sales, advertising or any other purposes shall automatically terminate this NOA. Failure to comply with any section of this NOA shall be cause for termination and removal of NOA.

ADVERTISEMENT: The NOA number preceded by the words Miami-Dade County, Florida, and followed by the expiration date may be displayed in advertising literature. If any portion of the NOA is displayed, then it shall be done in its entirety.

INSPECTION: A copy of this entire NOA shall be provided to the user by the manufacturer or its distributors and shall be available for inspection at the job site at the request of the Building Official.

This NOA revises NOA# 13-1009.05 and consists of this page 1 and evidence pages E-1 and E-2, as well as approval document mentioned above.

The submitted documentation was reviewed by Manuel Perez, P.E.



MP
7/23/15

NOA No. 15-0612.12
Expiration Date: April 11, 2018
Approval Date: July 23 2015
Page 1

NOTICE OF ACCEPTANCE: EVIDENCE SUBMITTED

A. DRAWINGS

1. Manufacturer's die drawings and sections.
(Submitted under NOA No. 08-0820.14)
2. Drawing No. **5191-1**, titled "Vinyl Single Hung Window, Large Missile Impact", sheets 1 through 11 of 11, dated 08/07/08, with revision D dated 06/01/15, prepared by manufacturer, signed and sealed by Anthony Lynn Miller, P.E.

B. TESTS

1. Test reports on: 1) Air Infiltration Test, per FBC, TAS 202-94
2) Uniform Static Air Pressure Test, Loading per FBC, TAS 202-94
3) Water Resistance Test, per FBC, TAS 202-94
4) Large Missile Impact Test per FBC, TAS 201-94
5) Cyclic Wind Pressure Loading per FBC, TAS 203-94
6) Forced Entry Test, per FBC 2411.3.2.1, and TAS 202-94
along with marked-up drawings and installation diagram of a series SH-500 vinyl single hung tilt window, prepared by Fenestration Testing Laboratory, Inc., Test Report No. **FTL-5710**, dated 08/13/08, signed and sealed by Carlos S. Rionda, P.E.
(Submitted under NOA No. 08-0820.14)
2. Test reports on: 1) Air Infiltration Test, per FBC, TAS 202-94
2) Uniform Static Air Pressure Test, Loading per FBC, TAS 202-94
3) Water Resistance Test, per FBC, TAS 202-94
4) Large Missile Impact Test per FBC, TAS 201-94
5) Cyclic Wind Pressure Loading per FBC, TAS 203-94
6) Forced Entry Test, per FBC 2411.3.2.1, and TAS 202-94
along with marked-up drawings and installation diagram of an outswing French door, prepared by Architectural Testing, Inc., Test Report No. **ATI-84576.01-401-47**, dated 10/31/08, signed and sealed by Joseph A. Reed, P.E.
(Submitted under NOA No. 08-0820.14 - For Reference only)

C. CALCULATIONS

1. Anchor verification calculations and structural analysis, complying with **FBC-5th Edition (2014)**, dated 06/05/15, prepared by manufacturer, signed and sealed by Anthony Lynn Miller, P.E.
2. Glazing complies with **ASTM E1300-04**

D. QUALITY ASSURANCE

1. Miami-Dade Department of Regulatory and Economic Resources (RER).

Manuel Perez, P.E.
Product Control Examiner
NOA No. 15-0612.12
Expiration Date: April 11, 2018
Approval Date: July 23 2015

NOTICE OF ACCEPTANCE: EVIDENCE SUBMITTED

E. MATERIAL CERTIFICATIONS

1. Notice of Acceptance No. **14-0916.10** issued to **Kuraray America, Inc.** for their "**Kuraray Butacite® PVB Glass Interlayer**" dated 04/25/15, expiring on 12/11/16.
2. Notice of Acceptance No. **12-1017.02** issued to **Quanex Building Products, Inc.**, for their "**White Rigid PVC Exterior Extrusions for Windows and Doors**" dated 02/07/13, expiring on 12/26/16.

F. STATEMENTS

1. Statement letter of conformance, complying with **FBC-5th Edition (2014)**, dated June 1, 2015, issued by manufacturer, signed and sealed by Anthony Lynn Miller, P.E.
2. Statement letter of no financial interest, dated June 1, 2015, issued by manufacturer, signed and sealed by Anthony Lynn Miller, P.E.

G. OTHERS

1. Notice of Acceptance No. **13-1009.05**, issued to PGT Industries for their Series "**SH-500 Vinyl**" White PVC Single Hung Window - L.M.I." approved on 11/14/13 and expiring on 01/08/19.



Manuel Perez, P.E.
Product Control Examiner

NOA No. 15-0612.12

Expiration Date: April 11, 2018

Approval Date: July 23 2015

GENERAL NOTES: LARGE MISSILE IMPACT SINGLE HUNG BOX FRAME AND INTEGRAL FIN WINDOWS

1. GLAZING OPTIONS:
- A. 3/4" LAMI I.G. GLASS COMPRISED OF (1) LITE OF 1/8" TEMPERED OR ANNEALED GLASS, AIRSPACE AND 5/16" LAMINATED GLASS WHICH IS COMPRISED OF (2) LITES OF 1/8" ANNEALED GLASS WITH AN .090 INTERLAYER OF BUTACITE® PVB BY KURARAY AMERICA, INC.
 - B. 7/8" LAMI I.G. GLASS COMPRISED OF (1) LITE OF 1/8" TEMPERED OR ANNEALED GLASS, AIRSPACE AND 5/16" LAMINATED GLASS WHICH IS COMPRISED OF (2) LITES OF 1/8" ANNEALED GLASS WITH AN .090 INTERLAYER OF BUTACITE® PVB BY KURARAY AMERICA, INC.
2. CONFIGURATIONS: 1/1 AND PROVIEW
3. DESIGN PRESSURES: +60/-70 PSF (ALL GLASS TYPES LISTED ABOVE) 
- A. NEGATIVE DESIGN LOADS BASED ON TESTED PRESSURE AND GLASS TABLES ASTM E 1300.
 - B. POSITIVE DESIGN LOADS BASED ON WATER TEST PRESSURE AND GLASS TABLES ASTM E 1300.
 - C. IF A TEMPERED CAP IS USED MAX. DP IS -50/+50 PSF.
4. ANCHORAGE: THE 33 1/3% STRESS INCREASE HAS NOT BEEN USED IN THE DESIGN OF THIS PRODUCT. MATERIALS, INCLUDING BUT NOT LIMITED TO STEEL SCREWS, THAT COME INTO CONTACT WITH OTHER DISSIMILAR MATERIALS SHALL MEET THE REQUIREMENTS OF THE FLORIDA BUILDING CODE, CURRENT EDITION. SEE SHEETS 9 THROUGH 11 FOR ANCHORAGE DETAILS.
5. SHUTTERS ARE NOT REQUIRED. FOR INSTALLATION OF UNITS ABOVE 30 FEET FROM GRADE IN THE HVHZ THE EXTERIOR CAP OF INSULATED GLASS UNITS MUST BE TEMPERED. 
6. REFERENCES: TEST REPORTS FTL-5710.
ANSI/AF&PA NDS FOR WOOD CONSTRUCTION
ADM ALUMINUM DESIGN MANUAL
QUANEX BUILDING PRODUCTS, INC. (WHITE RIGID PVC EXTERIOR EXTRUSIONS FOR WINDOWS AND DOORS)
7. THIS PRODUCT HAS BEEN DESIGNED & TESTED TO COMPLY WITH THE REQUIREMENTS OF THE FLORIDA BUILDING CODE, INCLUDING THE HIGH VELOCITY HURRICANE ZONE (HVHZ).

NOA DRAWING TABLE OF CONTENTS

	SHEET
GENERAL NOTES.....	1
ELEVATIONS.....	2
GLAZING DETAILS.....	3
GLAZING DETAILS.....	4
SECTIONS, I.F. FRAME.....	5
SECTIONS, BOX FRAME.....	6
PARTS LIST.....	7
EXTRUSIONS.....	8
ANCHORAGE SPACING, BOX FRAME... 9	
ANCHORAGE DETAILS, BOX FRAME.....	10
ANCHORAGE DETAILS, I.F. FRAME.....	11

PRODUCT REVISED
as complying with the Florida
Building Code
Acceptance No. 15-0612.12
Expiration Date April 2018
By 
Miami Trade Product Control

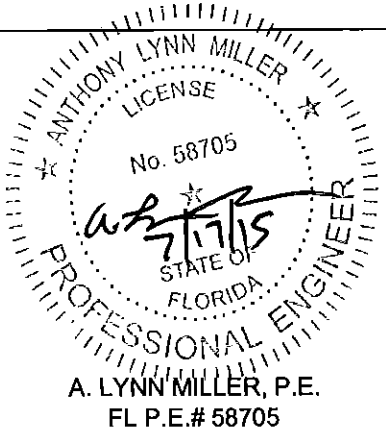

Revised By:	Date:	Revisions:	
SC	06/01/15	D	REVISED NOTE BLOCK
Revised By:	Date:	Revisions:	
D.G.	12/18/08	B	NO CHANGE THIS SHEET
Revised By:	Date:	Revisions:	
JJ	10/07/11	C	2010 FBC UPDATE
Drawn By:	Date:	Checked By:	Date:
D.G.	8/07/08		

1070 TECHNOLOGY DRIVE
N. VENICE, FL 34275

P.O. BOX 1529
N. VENICE, FL 34274
FL COA #29296



Description:				
GENERAL NOTES				
Title:				
Vinyl Single Hung Window, Large Missile Impact				
Series/Model:	Scale:	Sheet:	Drawing No.	Rev.
SH500	NTS	1 of 11	5191-1	D

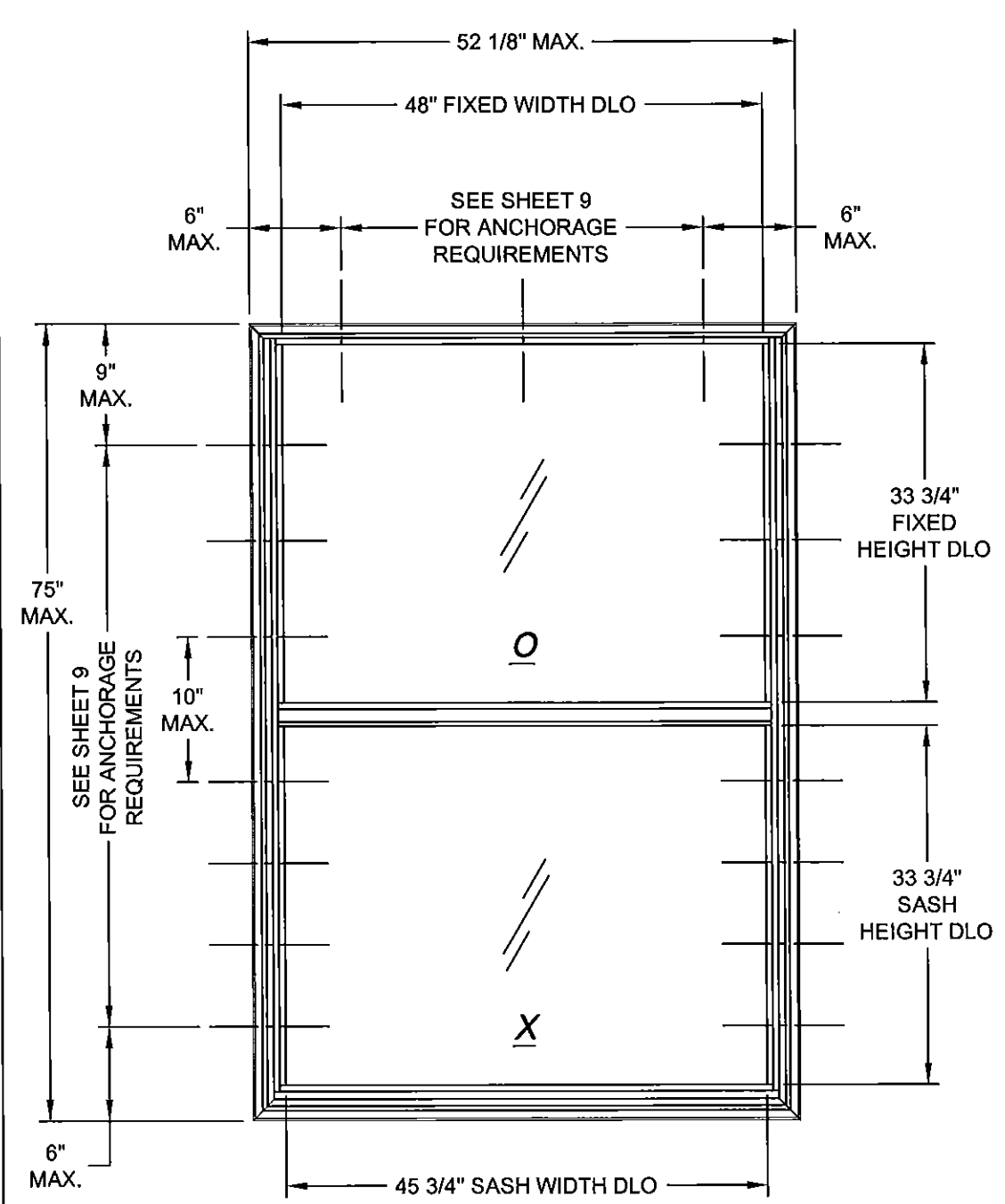

BOX FRAME
MAX. SIZE = 52.125" X 75"

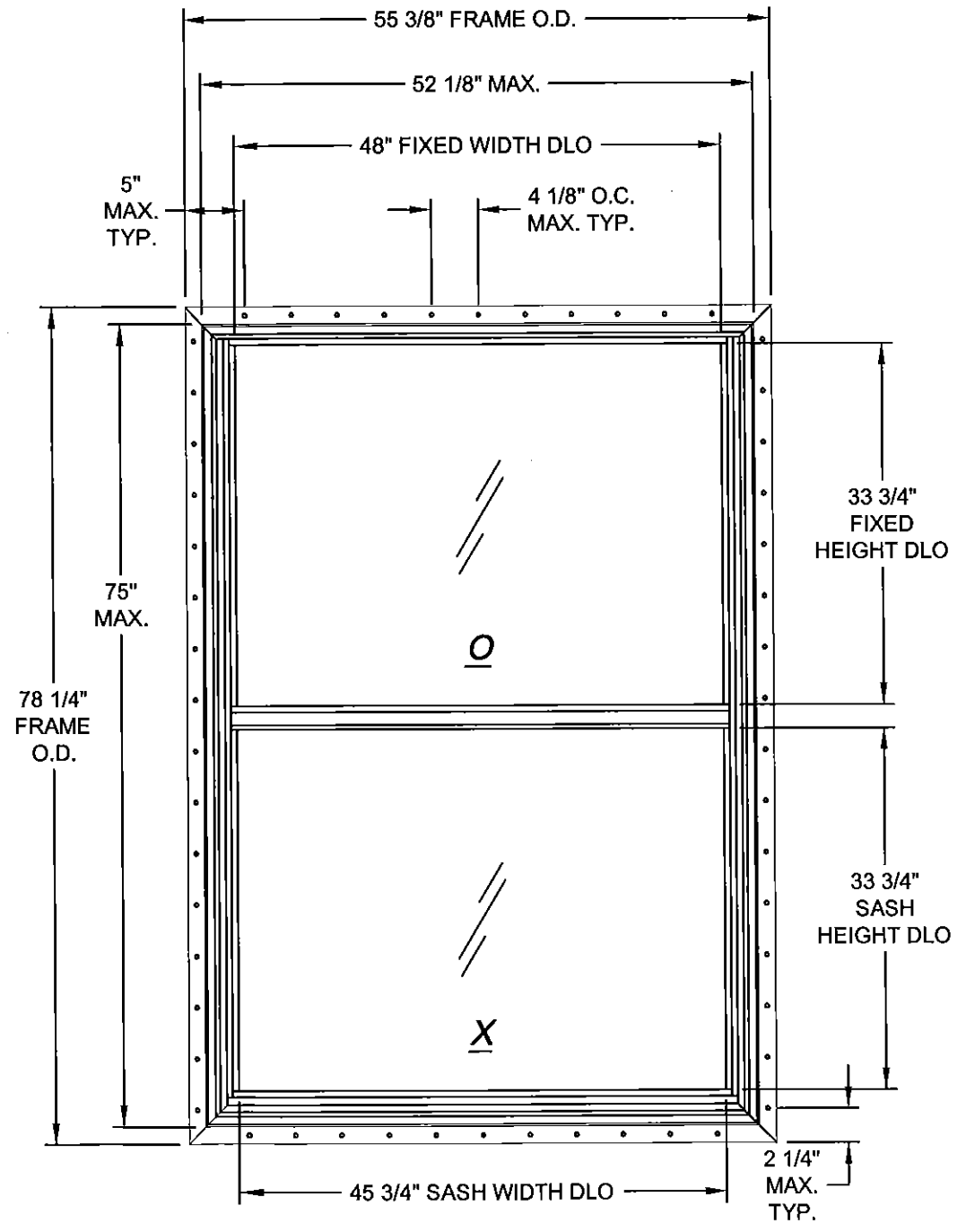

INTEGRAL FIN
MAX. SIZE = 52.125" X 75"

- NOTE:**
1. FOR BOX FRAME SECTIONS SEE SHEET 6 AND ANCHORAGE INFORMATION SEE SHEETS 9 AND 10.
 2. FOR INTEGRAL FIN FRAME SECTIONS SEE SHEET 5 AND ANCHORAGE INFORMATION SEE SHEET 11.

Revised By: SC	Date: 06/01/15	Revisions: D	NO CHANGES THIS SHEET
Revised By: D.G.	Date: 12/18/08	Revisions: B	ADDED 10" MAX. DIMENSION TO BOX FRAME ELEVATION
Revised By: JJ	Date: 10/07/11	Revisions: C	NO CHANGE THIS SHEET
Drawn By: D.G.	Date: 08/07/08	Checked By:	Date:

1070 TECHNOLOGY DRIVE
N. VENICE, FL 34275

P.O. BOX 1529
N. VENICE, FL 34274
FL COA #29296



Description: ELEVATIONS				
Title: Vinyl Single Hung Window, Large Missile Impact				
Series/Model: SH500	Scale: NTS	Sheet: 2 of 11	Drawing No. 5191-1	Rev. D

PRODUCT REVISED
as complying with the Florida
Building Code
Acceptance No. 15-0612.12
Expiration Date April 11, 2018
By: *Manuel*
Missile Product Control

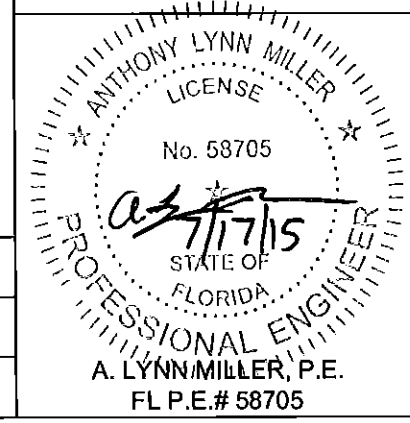

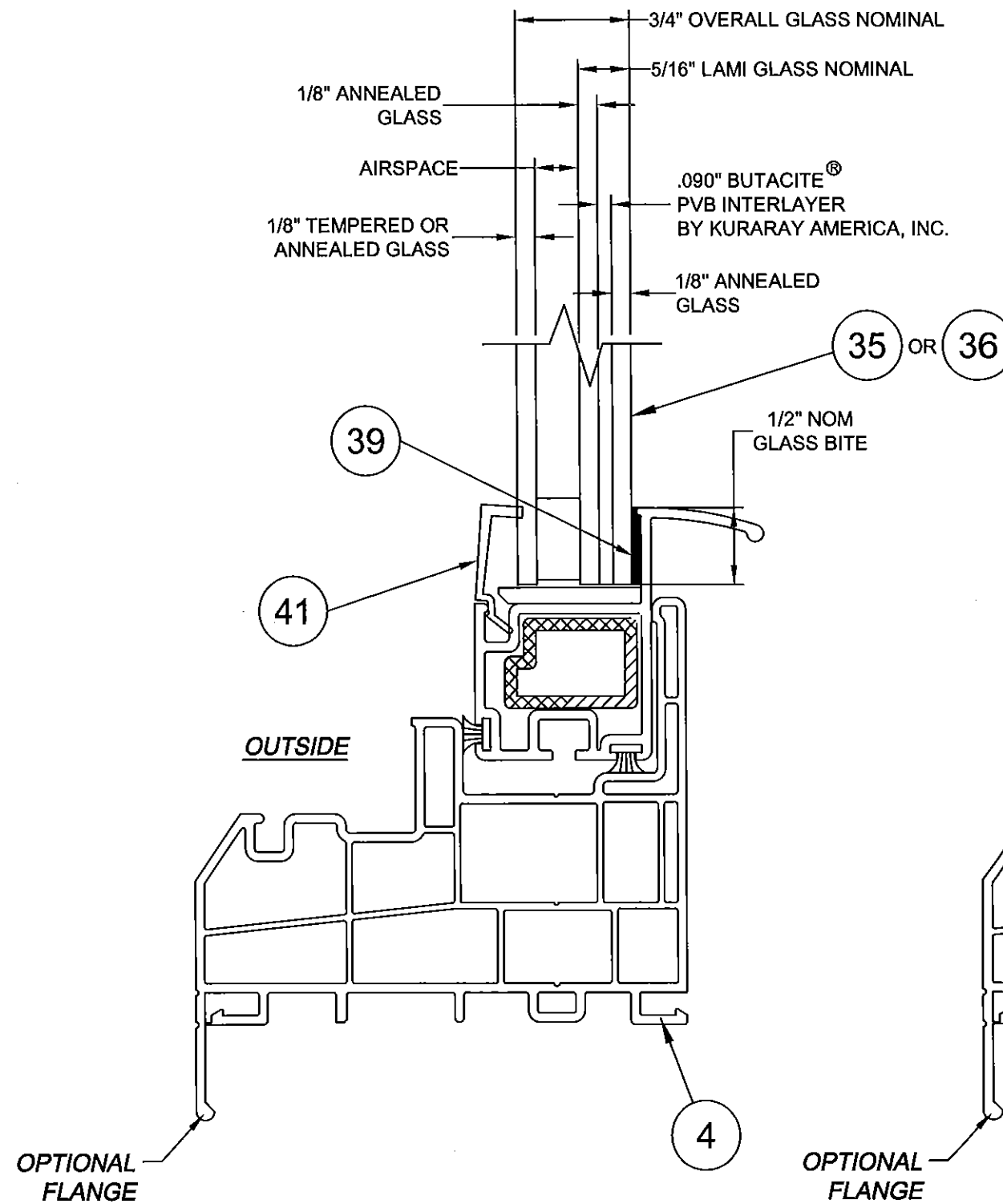

3/4" LAMI I.G. GLAZING DETAIL
WITH 5/16" LAMI GLASS AND 1/8" CAP
BOX OR INTEGRAL FIN FRAME
(BOX FRAME SHOWN)

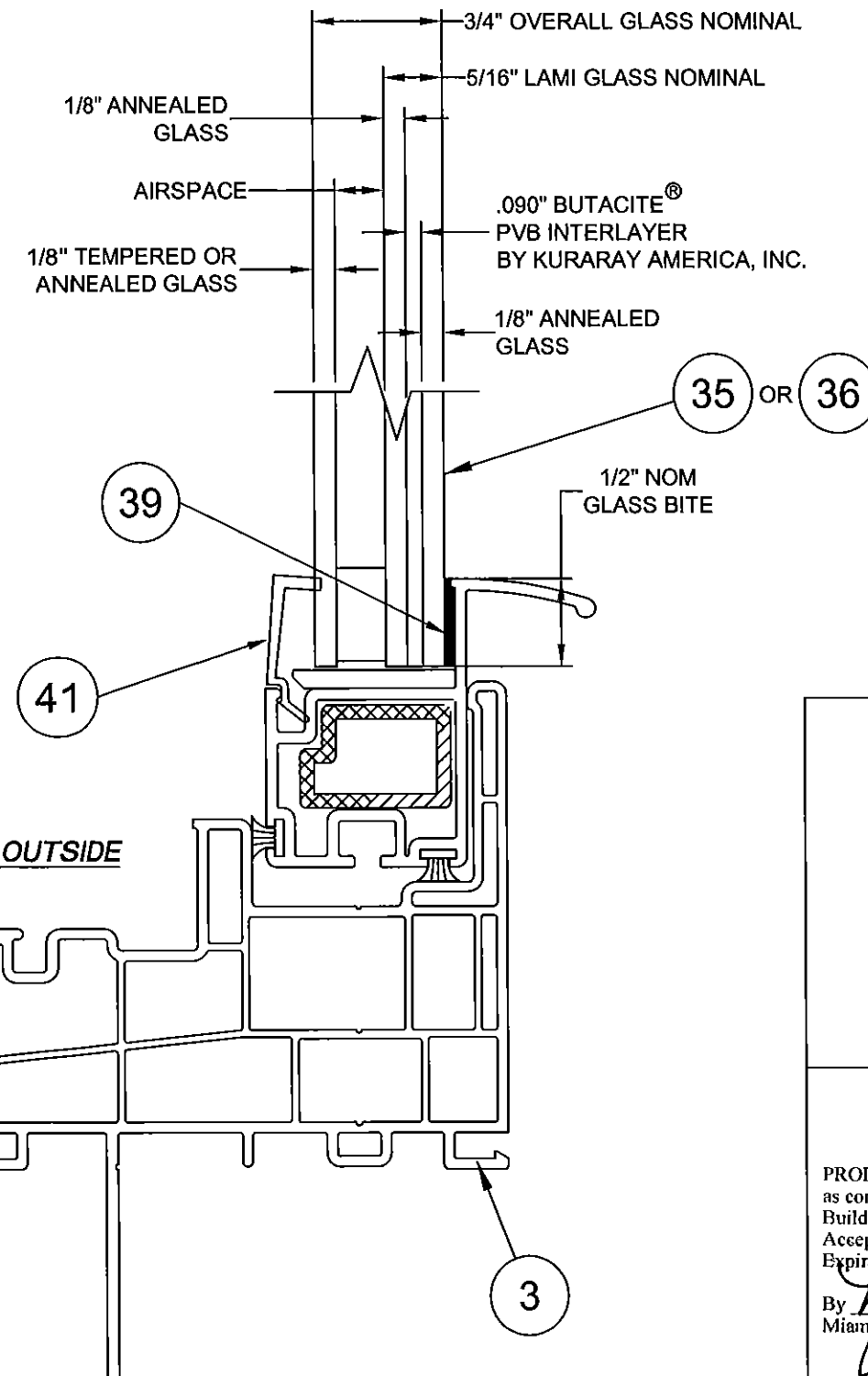

3/4" LAMI I.G. GLAZING DETAIL
WITH 5/16" LAMI GLASS AND 1/8" CAP
BOX OR INTEGRAL FIN FRAME
(INTEGRAL FIN FRAME SHOWN)

PRODUCT REVISED
as complying with the Florida
Building Code
Acceptance No. 15-0612.12
Expiration Date April 11, 2018
By *Manuel P. Paez*
Miami Dade Product Control

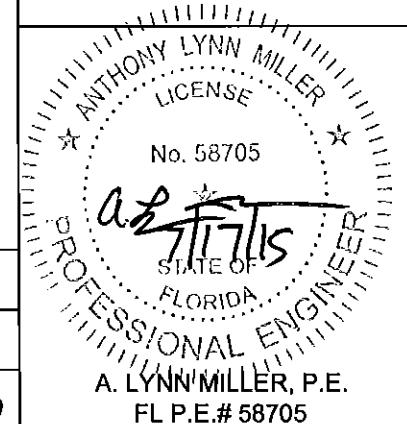

Revised By: SC	Date: 06/01/15	Revisions: D	NO CHANGES THIS SHEET
Revised By: D.G.	Date: 12/18/08	Revisions: B	NO CHANGE THIS SHEET
Revised By: JJ	Date: 10/07/11	Revisions: C	NO CHANGE THIS SHEET
Drawn By: D.G.	Date: 08/07/08	Checked By:	Date:

1070 TECHNOLOGY DRIVE
N. VENICE, FL 34275
P.O. BOX 1529
N. VENICE, FL 34274
FL COA #29296



Description: GLAZING DETAILS	Rev: D
Title: Vinyl Single Hung Window, Large Missile Impact	
Series/Model: SH500	Scale: Full
Sheet: 3 of 11	Drawing No. 5191-1

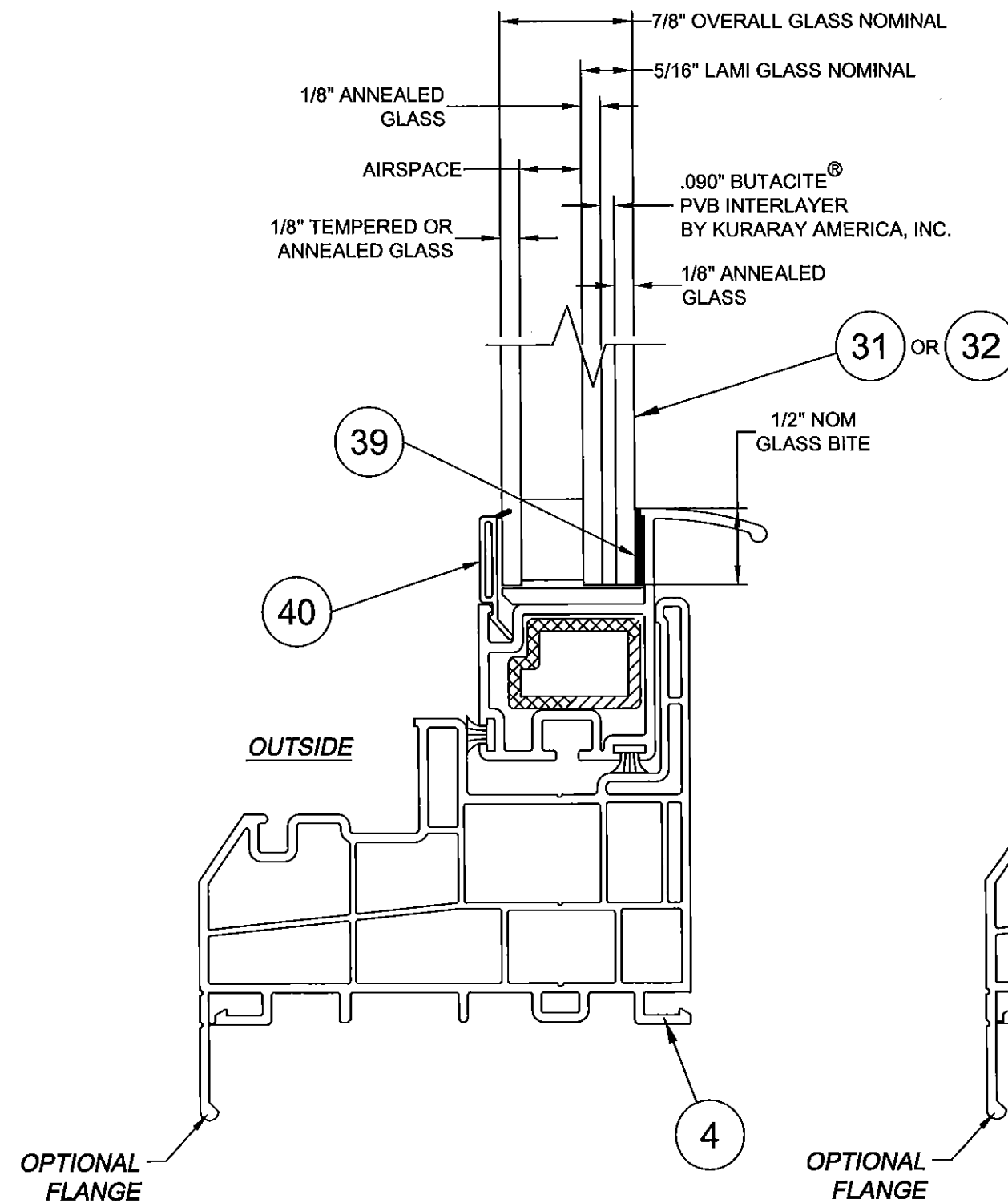

7/8" LAMI I.G. GLAZING DETAIL
WITH 5/16" LAMI GLASS AND 1/8" CAP
BOX OR INTEGRAL FIN FRAME
(BOX FRAME SHOWN)

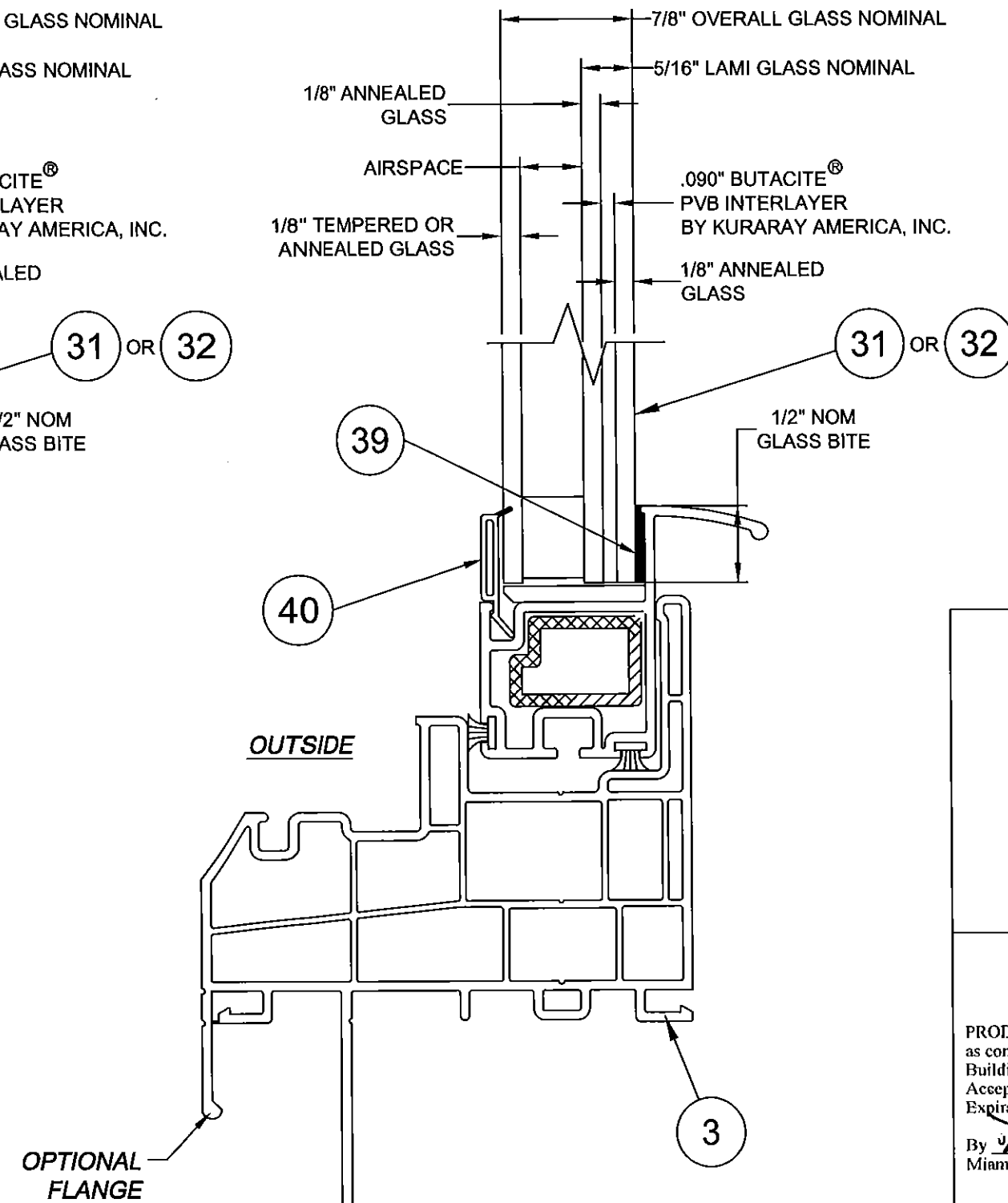

7/8" LAMI I.G. GLAZING DETAIL
WITH 5/16" LAMI GLASS AND 1/8" CAP
BOX OR INTEGRAL FIN FRAME
(INTEGRAL FIN FRAME SHOWN)

PRODUCT REVISED
as complying with the Florida
Building Code
Acceptance No. 15-0612.12
Expiration Date April 11, 2018
By *Manuel Pera*
Miami Made Product Control

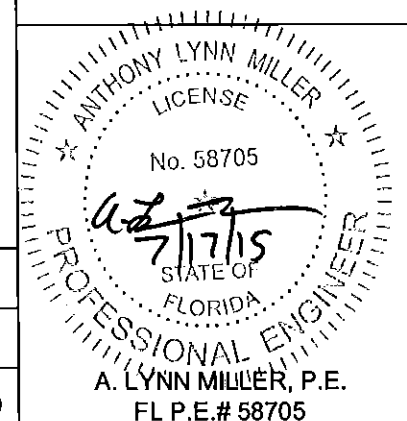

Revised By:	Date:	Revisions:	
SC	06/01/15	D	NO CHANGES THIS SHEET
Revised By:	Date:	Revisions:	
D.G.	12/18/08	B	NO CHANGE THIS SHEET
Revised By:	Date:	Revisions:	
JJ	10/07/11	C	NO CHANGE THIS SHEET
Drawn By:	Date:	Checked By:	Date:
D.G.	08/07/08		

1070 TECHNOLOGY DRIVE
N. VENICE, FL 34275
P.O. BOX 1529
N. VENICE, FL 34274
FL COA #29296



Description:	GLAZING DETAILS				
Title:	Vinyl Single Hung Window, Large Missile Impact				
Series/Model:	SH500	Scale:	NTS	Sheet:	4 of 11
				Drawing No.	5191-1
				Rev:	D

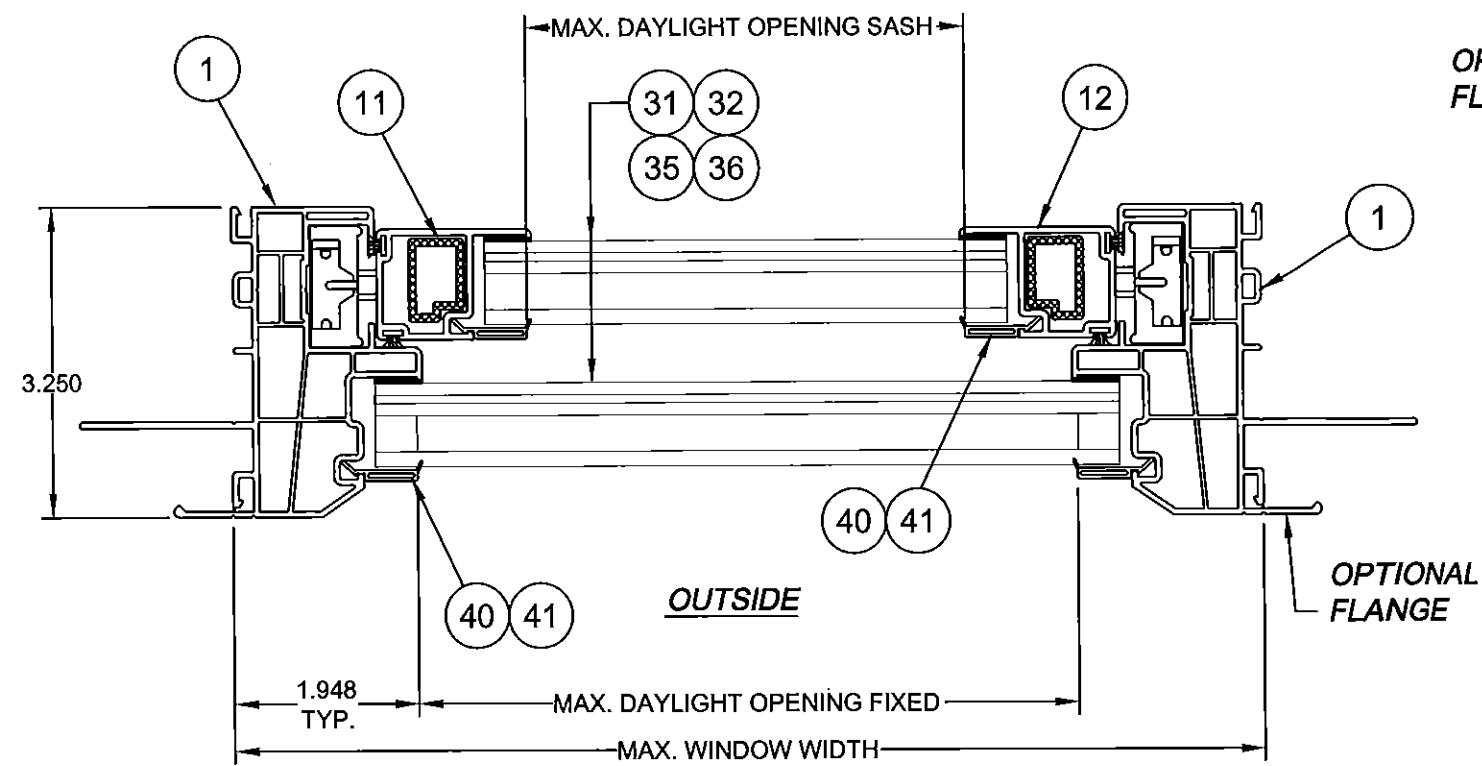

**HORIZONTAL SECTION
(INTEGRAL FIN)**

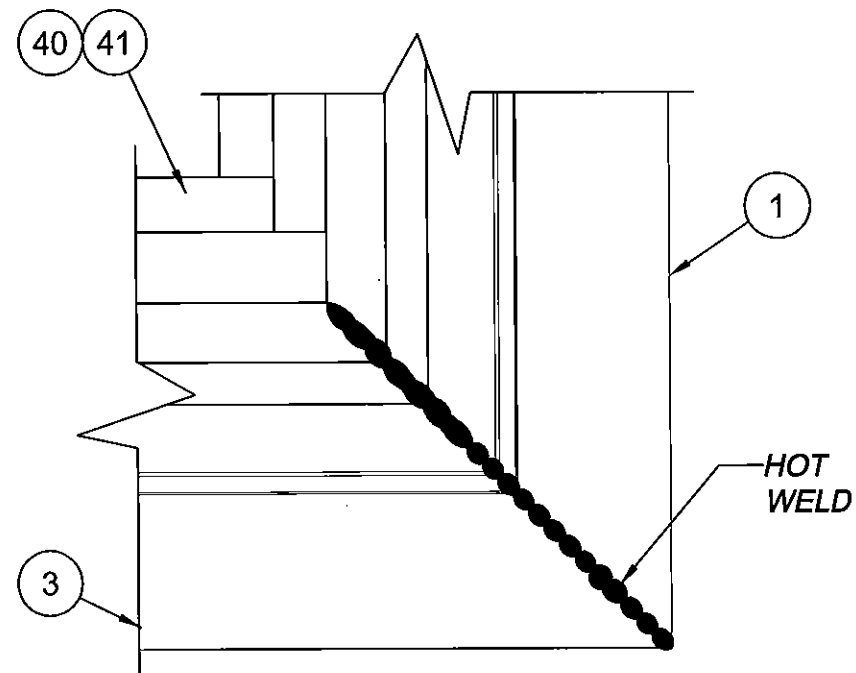

**HOT WELD CORNER ASSEMBLY
(INTEGRAL FIN)**

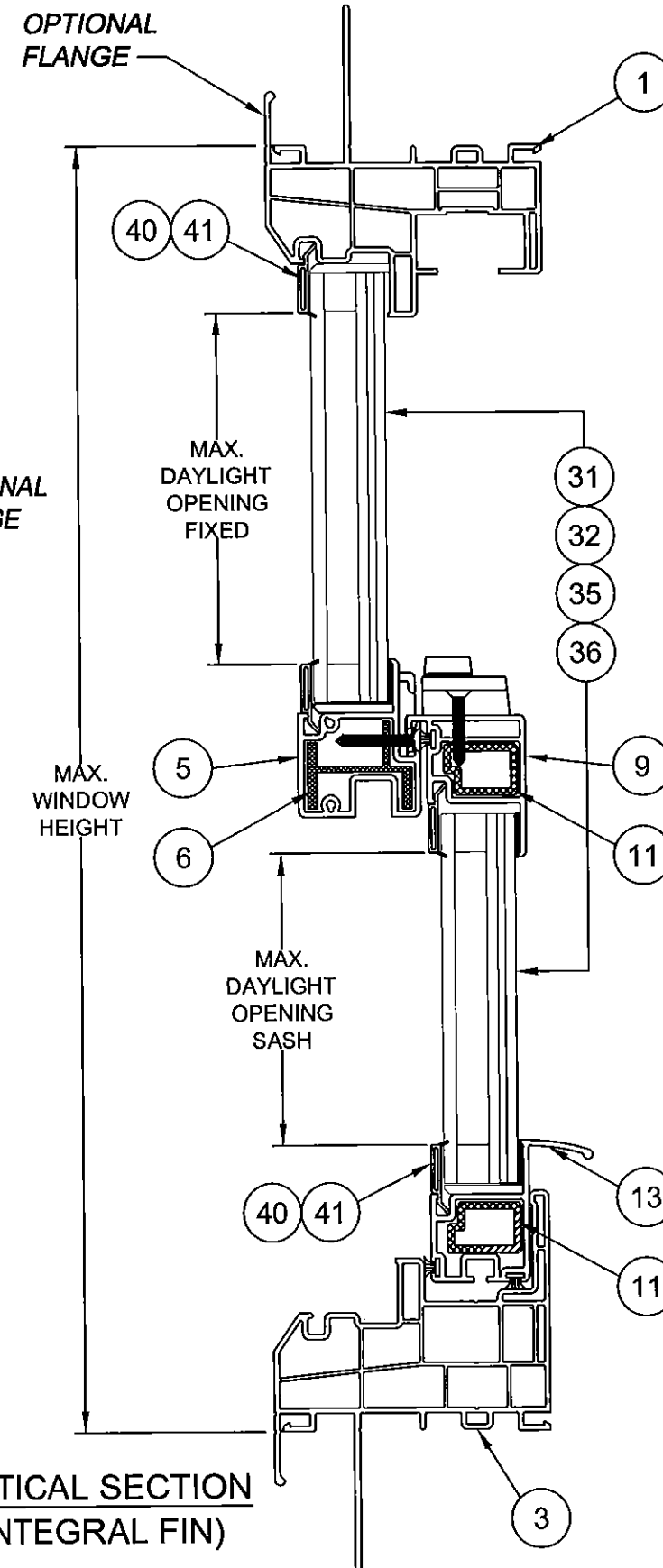

**VERTICAL SECTION
(INTEGRAL FIN)**

PRODUCT REVISED
as complying with the Florida
Building Code
Acceptance No. 15-0612.12
Expiration Date April 11, 2018
By *Manuel Pera*
Miami Dade Product Control

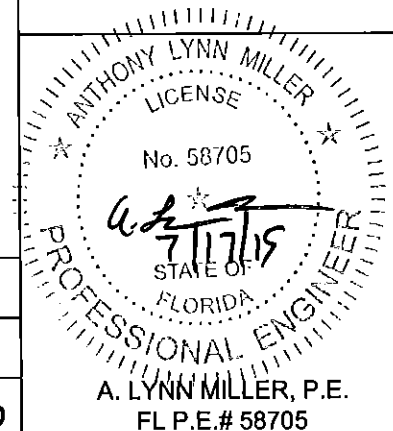

Revised By: SC	Date: 08/01/15	Revisions: D	NO CHANGES THIS SHEET
Revised By: D.G.	Date: 12/18/08	Revisions: B	NO CHANGE THIS SHEET
Revised By: JJ	Date: 10/07/11	Revisions: C	NO CHANGE THIS SHEET
Drawn By: D.G.	Date: 08/07/08	Checked By:	Date:

1070 TECHNOLOGY DRIVE
N. VENICE, FL 34275
P.O. BOX 1529
N. VENICE, FL 34274
FL COA #29296



Description: SECTIONS, INTEGRAL FIN FRAME	Series/Model: SH500	Scale: NTS	Sheet: 5 of 11	Drawing No. 5191-1	Rev: D
Title: Vinyl Single Hung Window, Large Missile Impact					

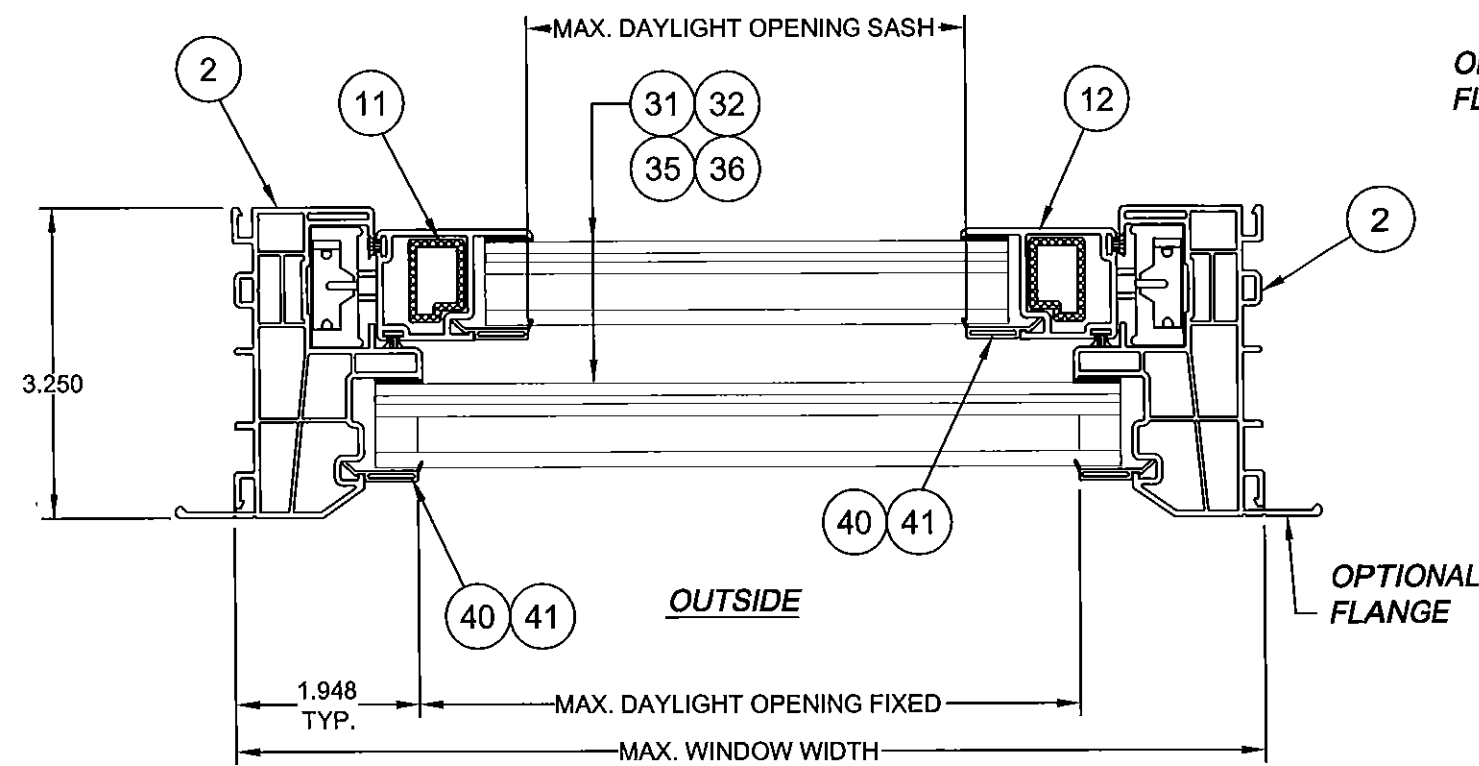

**HORIZONTAL SECTION
(BOX FRAME)**

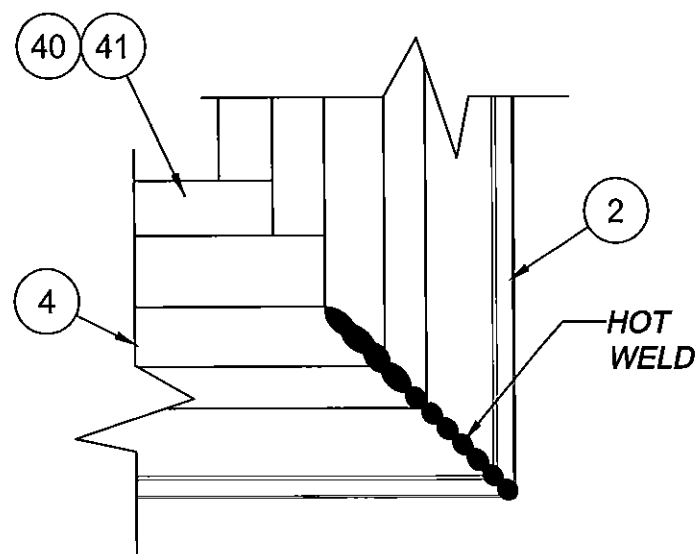

**HOT WELD CORNER ASSEMBLY
(BOX FRAME)**

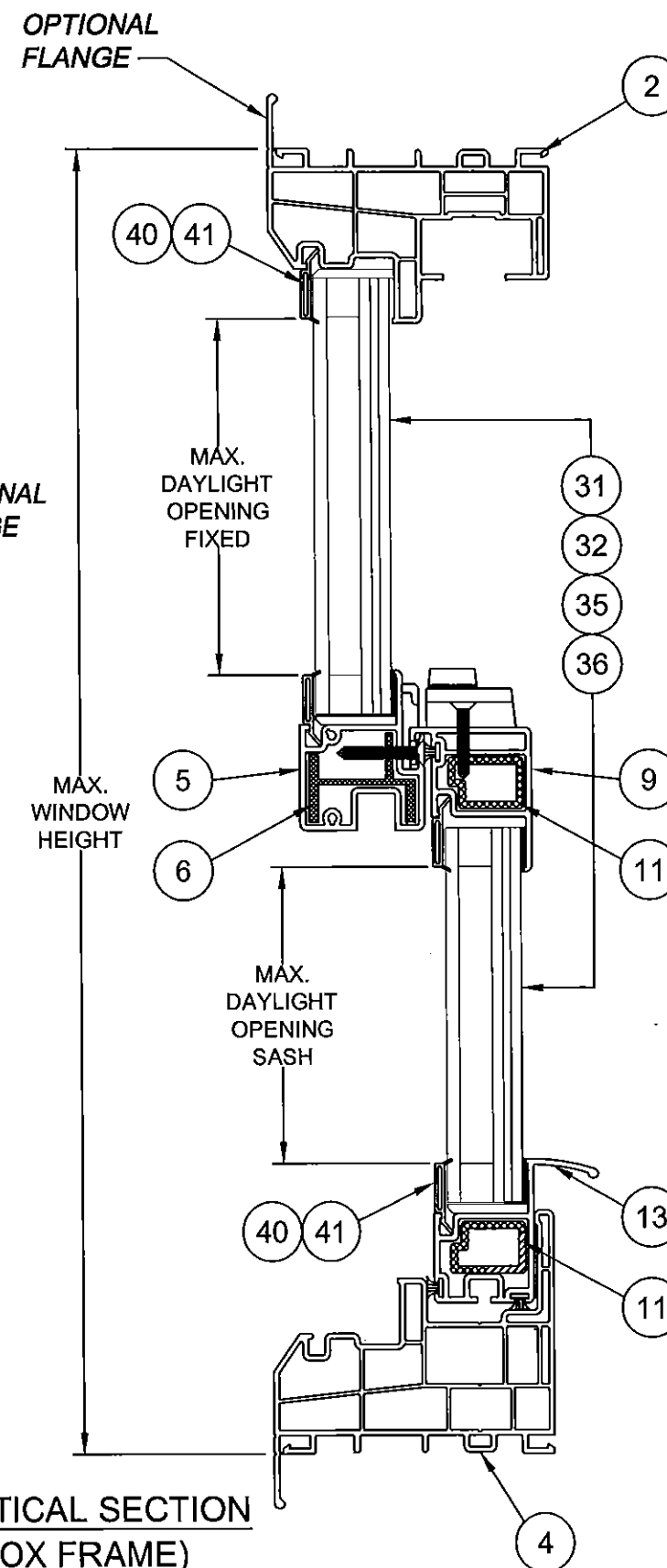

**VERTICAL SECTION
(BOX FRAME)**

PRODUCT REVISED
as complying with the Florida
Building Code
Acceptance No. 15-0612.12
Expiration Date April 11, 2018
By *Manuel Perez*
Miami Dade Product Control

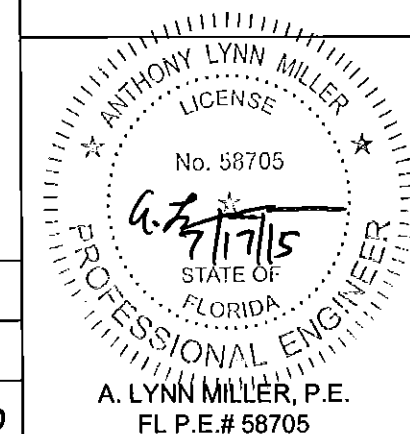

Revised By: SC	Date: 06/01/15	Revisions: D	NO CHANGES THIS SHEET
Revised By: D.G.	Date: 12/18/08	Revisions: B	NO CHANGE THIS SHEET
Revised By: JJ	Date: 10/07/11	Revisions: C	NO CHANGE THIS SHEET
Drawn By: D.G.	Date: 08/07/08	Checked By:	Date:

1070 TECHNOLOGY DRIVE
N. VENICE, FL 34275

P.O. BOX 1529
N. VENICE, FL 34274
FL COA #29296



Description: SECTIONS, BOX FRAME	Series/Model: SH500	Scale: Half	Sheet: 6 of 11	Drawing No. 5191-1	Rev. D
Title: Vinyl Single Hung Window, Large Missile Impact					

ITEM	DWG NO.	PART #	DESCRIPTION
1	9521	65163	INTEGRAL FIN FRAME HEAD & JAMB
2	9871	69871	BOX FRAME HEAD & JAMB
3	9520	65164	INTEGRAL FIN FRAME SILL
4	9870	69870	BOX FRAME SILL
5	7940	65102	FIXED MEETING RAIL
6	7126.1	65103	MEETING RAIL REINFORCEMENT
7	7942	65109	SASH STOP
8	8873	65117	BALANCE COVERS
9	7092	65105	SASH INTERLOCK
10		61644W	WSTP, .187 X .270 FIN SEAL
11	7092.1	65114	SASH REINFORCEMENT
12	7093	65106	SASH SIDE RAIL
13	7745	65113	SASH LIFT RAIL
14	1669	71669SP	MR SUPPORT PLATE
15	15B110	71694	TILT BALANCE SHOES
16	1686	7FPHSPSPF	PIVOT BARS
17		76208SLAW	CAM SWEEP LOCK
18		76133SLKW	CAM SWEEP LOCK KEEPER
19		79803WF	WEEP HOLE COVER
20		7675RHTL	RH TILT LATCH
21		7675LHTL	LH TILT LATCH
22		71669SP	ALUM. SCREW SUPPORT PLATE
23		71038W	INSTALL HOLE PLUG
24		71684K	SETTING BLOCK
25		71684AK	SETTING BLOCK - SELF ADHESIVE
26		76X1FPTWX	6 X 1" FH TECH (410 SS PAINTED)
27		7612FPTWX	6 X 1/2" FH (410 SS PAINTED)
28		76X2TPA410X	6 X 2" TH VINYL SCREW SS
29		78X114FPAB410X	#8 X 1 1/4"
30		8X1FPAX	#8 X 1"

ITEM	DWG NO.	PART #	DESCRIPTION
31			7/8" LAM I.G. GLASS: 1/8" TEMPERED OUTBOARD - AIRSPACE - 1/8" ANNEALED - .090" BUTACITE® PVB INTERLAYER - 1/8" ANNEALED (5/16" LAM)
32			7/8" LAM I.G. GLASS: 1/8" ANNEALED OUTBOARD - AIRSPACE - 1/8" ANNEALED - .090" BUTACITE® PVB INTERLAYER - 1/8" ANNEALED (5/16" LAM)
33			
34			
35			3/4" LAM I.G. GLASS: 1/8" TEMPERED OUTBOARD - AIRSPACE - 1/8" ANNEALED - .090" BUTACITE® PVB INTERLAYER - 1/8" ANNEALED (5/16" LAM)
36			3/4" LAM I.G. GLASS: 1/8" ANNEALED OUTBOARD - AIRSPACE - 1/8" ANNEALED - .090" BUTACITE® PVB INTERLAYER - 1/8" ANNEALED (5/16" LAM)
37			
38			
39			SILICONE DOW 1199
40	6492	65112	GLAZING BEAD
41	8483	65148	SDL GLAZING BEAD

NOTE:
ALL EXTRUDED VINYL MANUFACTURED
BY QUANEX BUILDING PRODUCTS, INC.

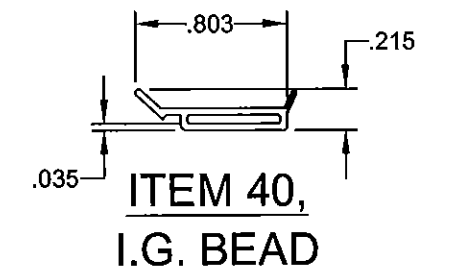

**ITEM 40,
I.G. BEAD**
MAT'L: White Ridged PVC
by Quanex Building Products, Inc.
DWG NO. 6492

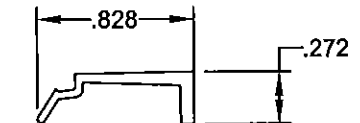

**ITEM 41,
SDL BEAD**
MAT'L: White Ridged PVC
by Quanex Building Products, Inc.
DWG NO. 8483

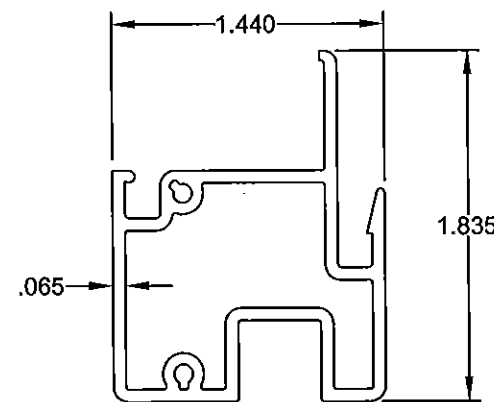

**ITEM 5,
FIXED MEETING RAIL**
MAT'L: White Ridged PVC
by Quanex Building Products, Inc.
DWG NO. 7940

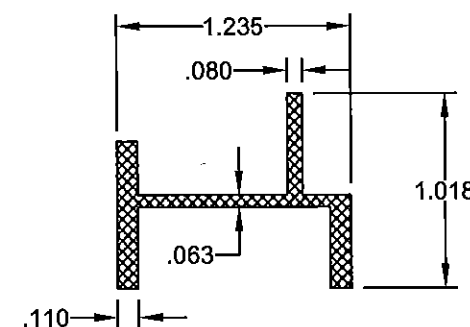

**ITEM 6,
FIXED MTG. RAIL REINF.**
MAT'L: Alum. (6063-T6)
DWG NO. 7126.1

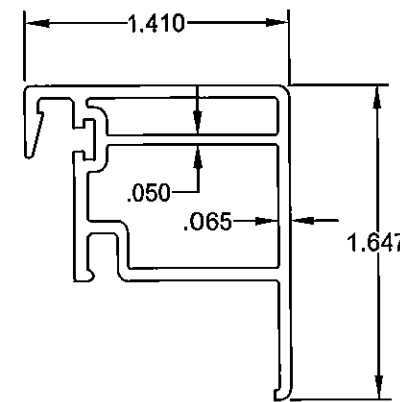

**ITEM 9,
SASH INTERLOCK**
MAT'L: White Ridged PVC
by Quanex Building Products, Inc.
DWG NO. 7092

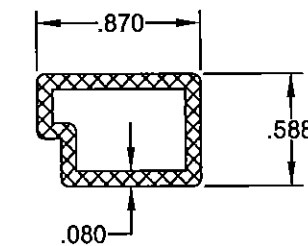

**ITEM 11,
SASH REINFORCEMENT**
MAT'L: Alum. (6063-T6)
DWG NO. 7092.1

PRODUCT REVISED
as complying with the Florida
Building Code
Acceptance No. 15-0612.12
Expiration Date April 11, 2018
By *Manuel Perez*
Miami Dade Product Control

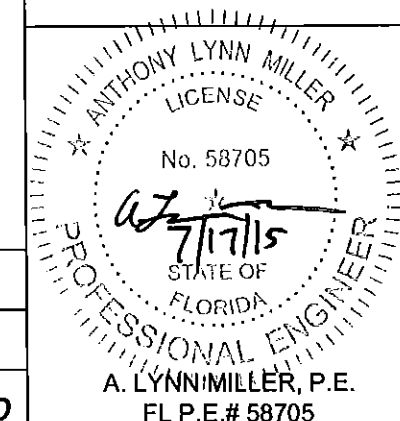

Revised By: SC	Date: 06/01/15	Revisions: D	NO CHANGES THIS SHEET
Revised By: D.G.	Date: 12/18/08	Revisions: B	ADDED DIMENSIONS TO ALUM. EXTRUSIONS
Revised By: JJ	Date: 10/07/11	Revisions: C	NO CHANGE THIS SHEET
Drawn By: D.G.	Date: 08/07/08	Checked By:	Date:

1070 TECHNOLOGY DRIVE
N. VENICE, FL 34275

P.O. BOX 1529
N. VENICE, FL 34274
FL COA #29296



Description: PARTS LIST AND EXTRUSIONS	Title: Vinyl Single Hung Window, Large Missile Impact
Series/Model: SH500	Scale: NTS
Sheet: 7 of 11	Drawing No. 5191-1
Rev. D	

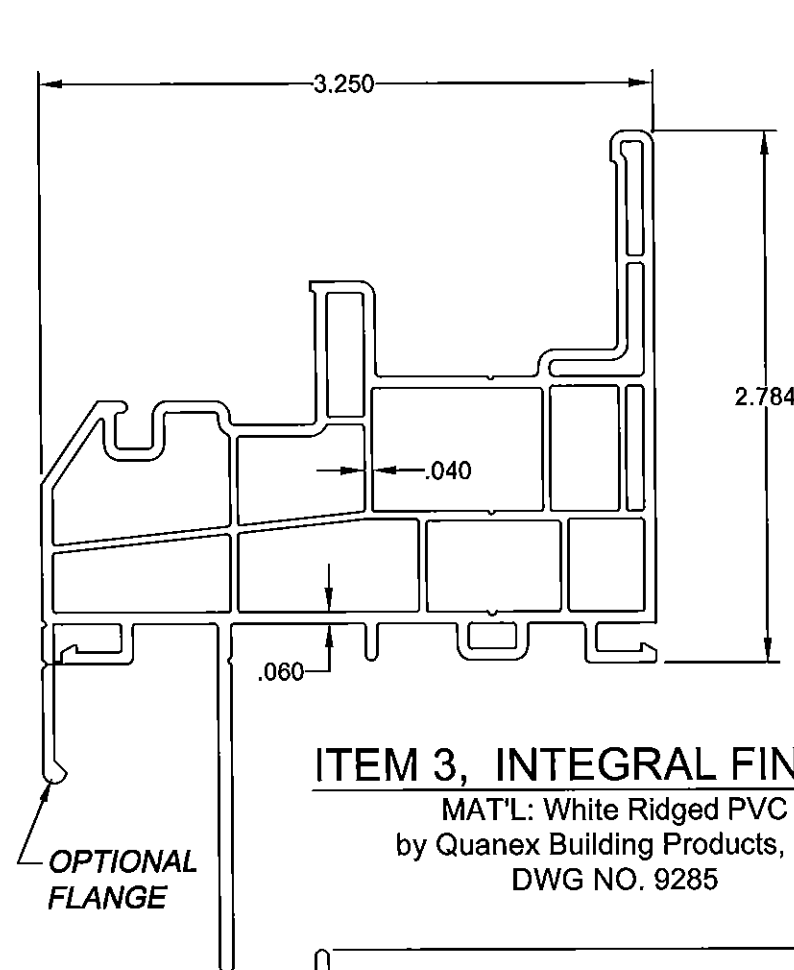

ITEM 3, INTEGRAL FIN SILL

MAT'L: White Ridged PVC
by Quanex Building Products, Inc.
DWG NO. 9285

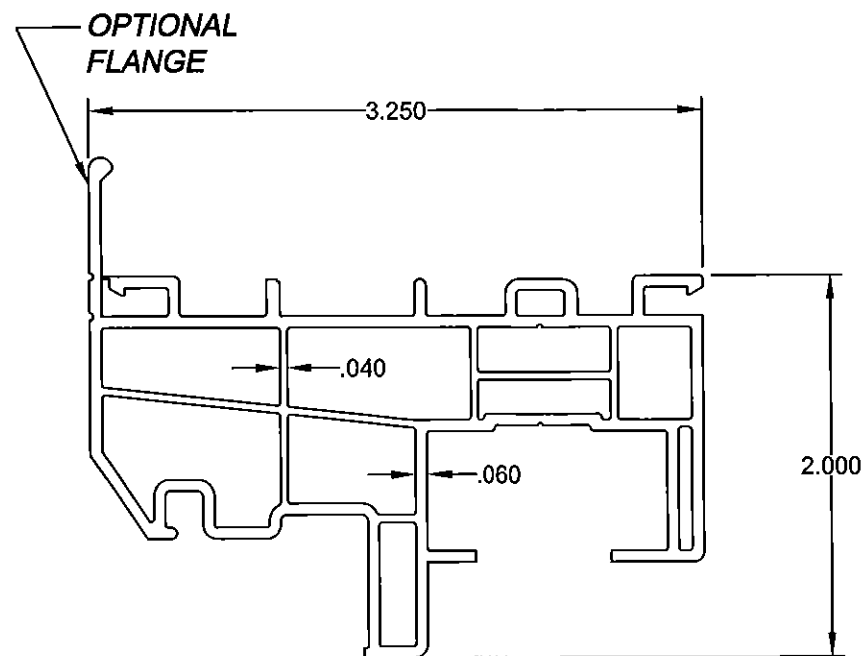

ITEM 2, BOX FRAME HEAD/JAMB

MAT'L: White Ridged PVC
by Quanex Building Products, Inc.
DWG NO. 9288

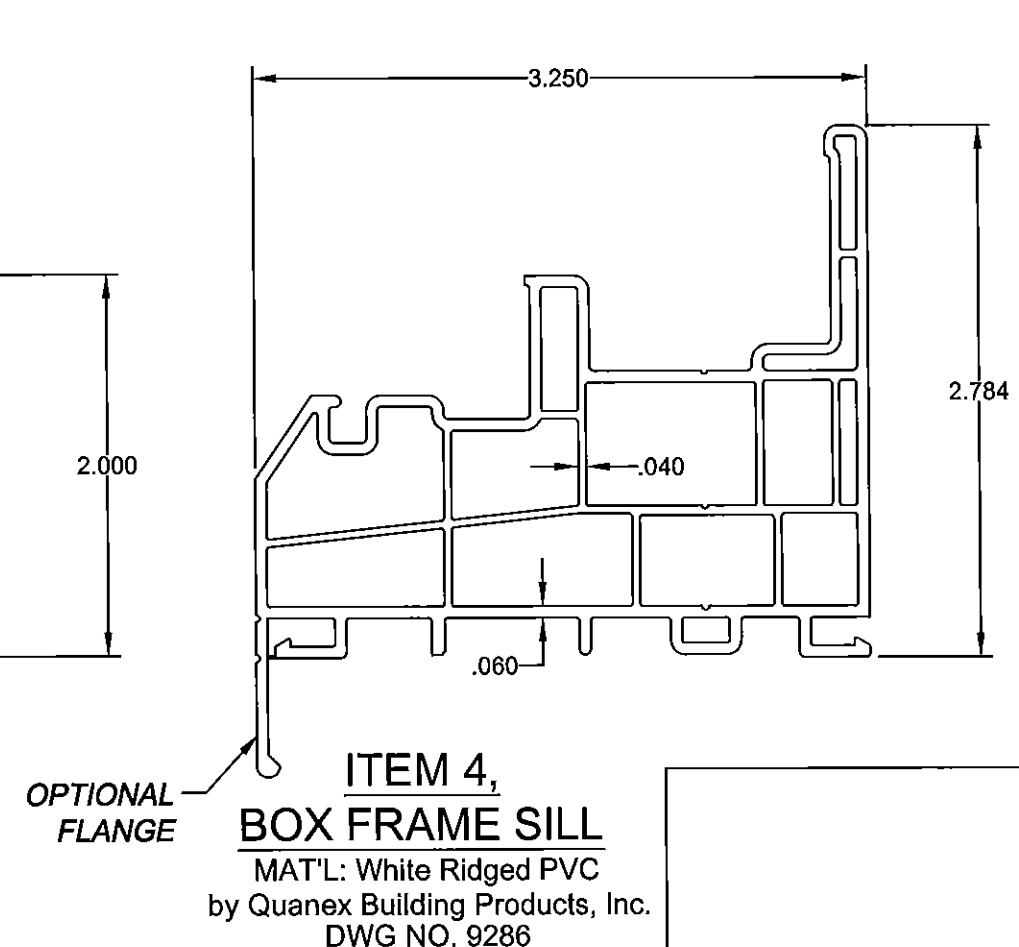

ITEM 4, BOX FRAME SILL

MAT'L: White Ridged PVC
by Quanex Building Products, Inc.
DWG NO. 9286

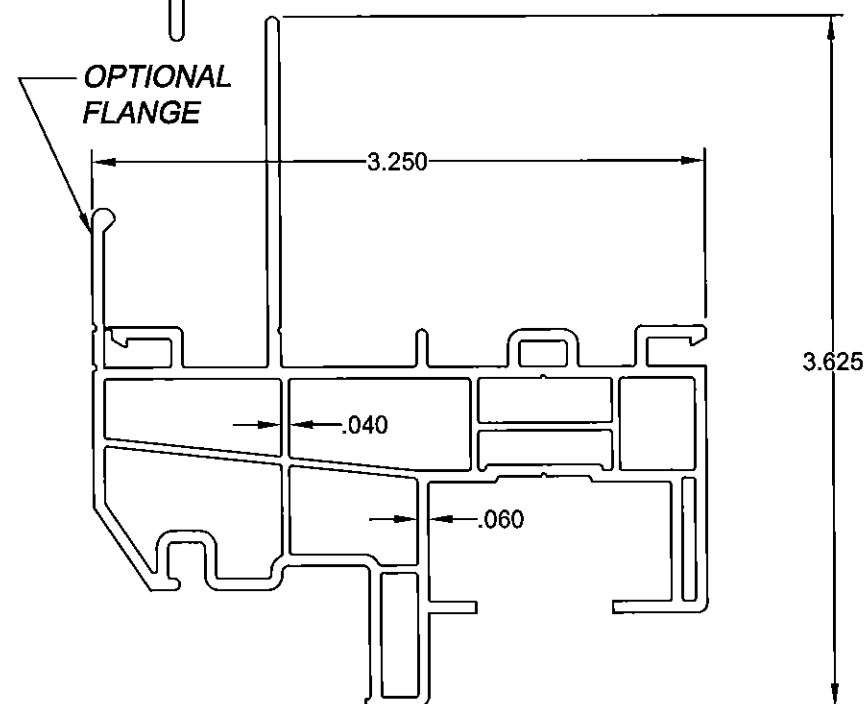

ITEM 1, INTEGRAL FIN HEAD/JAMB

MAT'L: White Ridged PVC by Quanex Building Products, Inc.
DWG NO. 9287

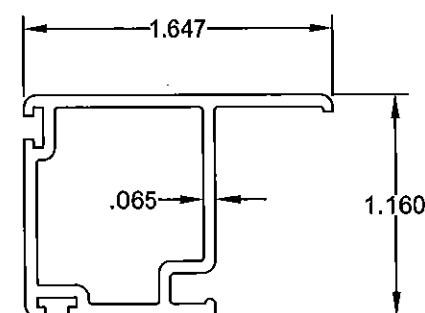

ITEM 12, SASH SIDE RAIL

MAT'L: White Ridged PVC
by Quanex Building Products, Inc.
DWG NO. 7093

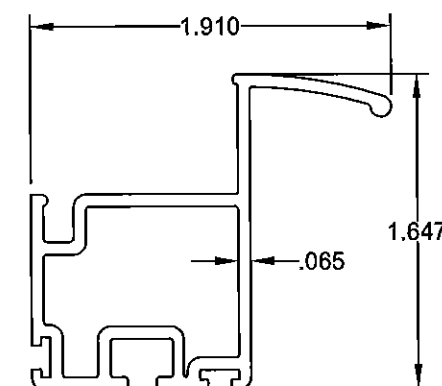

ITEM 13, SASH LIFT RAIL

MAT'L: White Ridged PVC
by Quanex Building Products, Inc.
DWG NO. 7745

PRODUCT REVISED
as complying with the Florida
Building Code
Acceptance No 15-0612.12
Expiration Date April 11, 2018
By *Manuel Miller*
Miami Dade Product Control

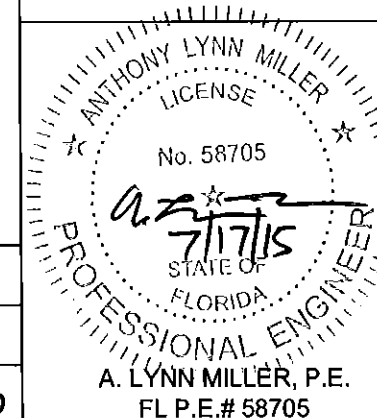

Revised By:	Date:	Revisions:	
SC	06/01/15	D	NO CHANGES THIS SHEET
Revised By:	Date:	Revisions:	
D.G.	12/18/08	B	NO CHANGE THIS SHEET
Revised By:	Date:	Revisions:	
JJ	10/07/11	C	NO CHANGE THIS SHEET
Drawn By:	Date:	Checked By:	Date:
D.G.	08/07/08		

1070 TECHNOLOGY DRIVE
N. VENICE, FL 34275

P.O. BOX 1529
N. VENICE, FL 34274
FL COA #29296



Description:	EXTRUSIONS				
Title:	Vinyl Single Hung Window, Large Missile Impact				
Series/Model:	SH500	Scale:	Half	Sheet:	8 of 11
Drawing No.	5191-1	Rev:	D		

ANCHOR QUANTITIES

TABLE 1

View		WINDOW WIDTH											
		1/1	16	20	24	28	32	36	40	44	48	52 1/8	
W I N D O W H E I G H T	Fixed	Sash	1/1	16	20	24	28	32	36	40	44	48	52 1/8
	36	24	2	2	2	2	2	3	3	3	3	3	
	25	45	30	1 1	1 1	1 1	1 1	1 1	1 1	1 1	1 1	1 2	1 2
	30	54	36	2	2	2	2	2	3	3	3	3	
	35	62 1/2	42	1 1	1 1	1 1	1 1	1 2	1 2	1 2	1 2	1 2	1 2
	40		48	2	2	2	2	2	3	3	3	3	
	45		54	2 2	2 2	2 2	2 2	2 2	2 2	2 2	2 3	2 3	2 3
	50		60	2	2	2	2	2	3	3	3	3	
	55		66	2 2	2 2	2 2	2 2	2 2	2 3	2 3	2 3	2 3	2 3
	60		72	2	2	2	2	2	3	3	3	3	
	62 1/2		75	2 3	2 3	2 3	2 3	2 3	2 3	3 3	3 3	3 4	3 4
				3 3	3 3	3 3	3 3	3 3	3 3	3 3	3 3	3 4	3 4

Example: 52.125 x 75 For 1/1 Window s

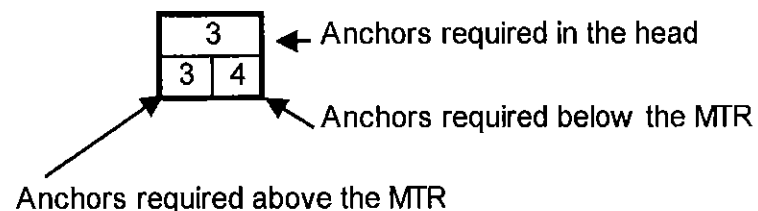

Example: 52.125 x 62.500 For View Window s

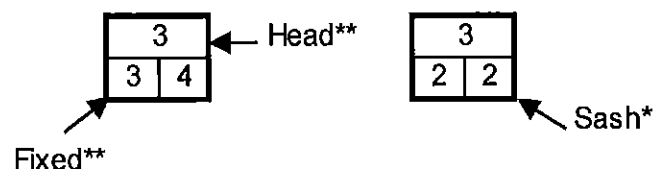

NOTE: FOR VIEW WINDOWS USE VIEW FIXED WINDOW HEIGHT FOR ANCHOR QUANTITY IN HEAD AND ABOVE THE MTR, AND USE THE VIEW SASH WINDOW HEIGHT FOR ANCHOR QUANTITY BELOW THE MTR. MAXIMUM HEIGHT FOR VIEW WINDOW IS 62 1/2".

NOTE: FOR VIEW WINDOW THE LARGEST CAN NOT EXCEED THE TESTED SIZE.

Revised By: SC	Date: 06/01/15	Revisions: D	ADDED GROUT-FILLED CMU
Revised By: D.G.	Date: 12/18/08	Revisions: B	ADDED AND MODIFIED VIEW WINDOW EXAMPLES
Revised By: JJ	Date: 10/07/11	Revisions: C	NO CHANGE THIS SHEET
Drawn By: D.G.	Date: 08/07/08	Checked By:	

1070 TECHNOLOGY DRIVE
N. VENICE, FL 34275

P.O. BOX 1529
N. VENICE, FL 34274
FL COA #29296



ANCHORAGE NOTES FOR BOX FRAME:

- ANCHOR TYPES: 1 - #10 SCREWS
2 - 3/16" ULTRACONS
(CONCRETE OR GROUT-FILLED CMU)
- ANCHOR LOCATIONS ARE BASED ON THE FOLLOWING DIMENSIONS.
HEAD - 6" MAX. FROM TOP CORNERS
JAMBS - 9" MAX. FROM TOP CORNERS*
(*NOT TO EXCEED 1/4 OF TOTAL WINDOW HEIGHT)
6" MAX. FROM BOTTOM CORNERS
4" MIN. BELOW MTG. RAIL
SILL - ANCHORS NOT REQUIRED
- INSTALL PER THE ADJACENT TABLE ANCHOR QUANTITIES USING THE DIMENSIONAL CRITERIA OF NOTE 2.
- ANCHORAGE SHOWN FOR BOX FRAME WITH OR WITHOUT OPTIONAL FLANGE.
- FOR INTEGRAL NAIL FIN FRAME ANCHORAGE, SEE SHEET 11.

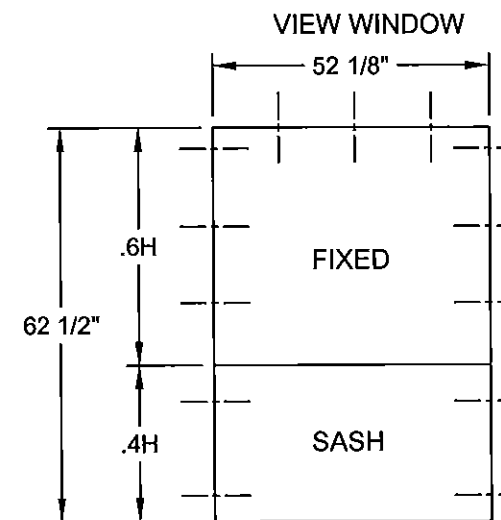
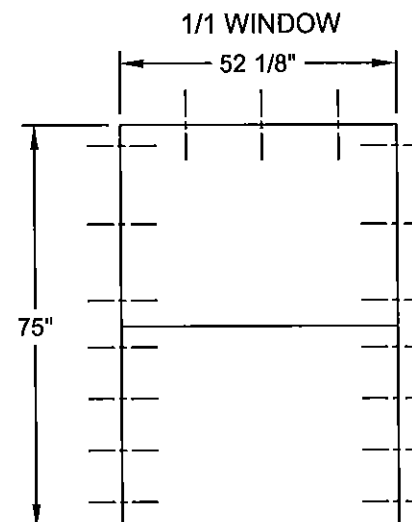

PRODUCT REVISED
as complying with the Florida
Building Code
Acceptance No. 15-0612.12
Expiration Date April 1, 2018
By *Manuel Perez*
Miami Trade Product Control

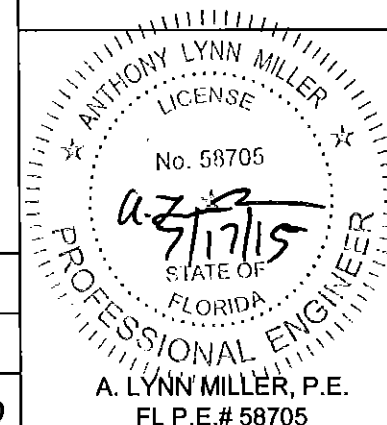

Description:	ANCHORAGE SPACING				
Title:	Vinyl Single Hung Window, Large Missile Impact				
Series/Model:	SH500	Scale:	NTS	Sheet:	9 of 11
Drawing No.	5191-1	Rev:	D		

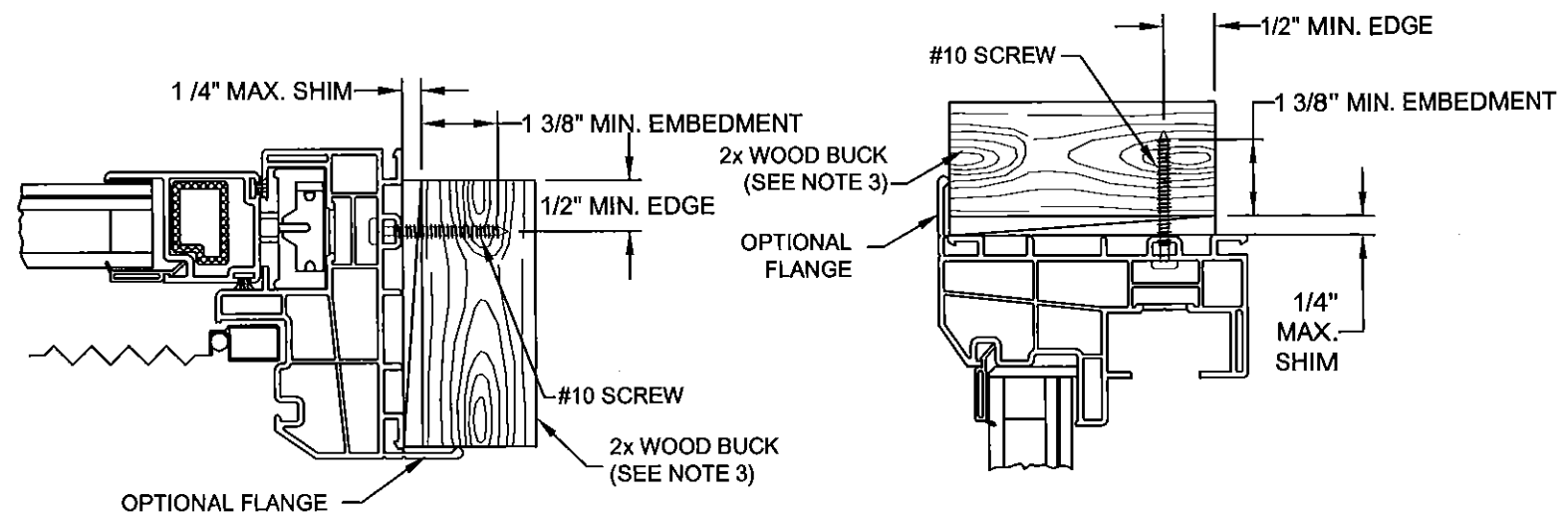

**JAMB W/ BOX FRAME
THROUGH FRAME INTO 2x WOOD**

**HEAD W/ BOX FRAME
THROUGH FRAME INTO 2x WOOD**

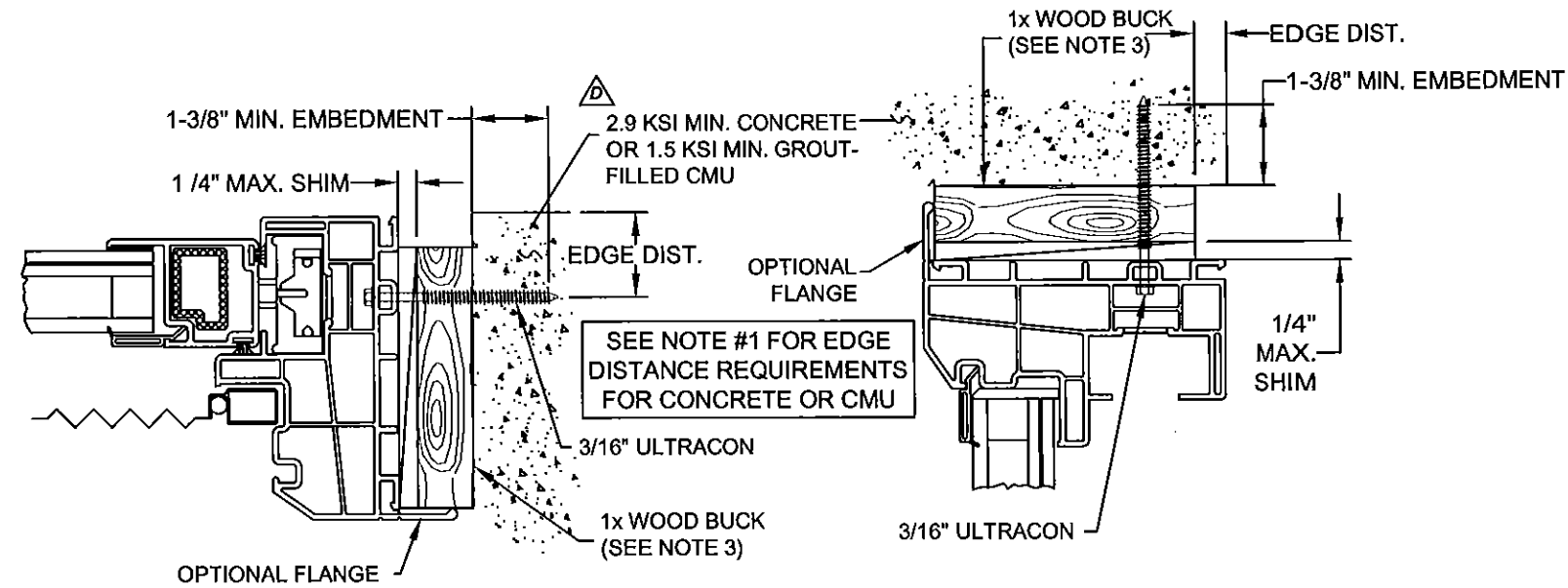

**JAMB W/ BOX FRAME
THROUGH FRAME INTO CONCRETE
1x BUCK OPTIONAL**

**HEAD W/ BOX FRAME
THROUGH FRAME INTO CONCRETE
1x BUCK OPTIONAL**

NOTES:

1. FOR CONCRETE (MIN. 2.9 KSI) APPLICATIONS IN MIAMI-DADE COUNTY, USE ONLY MIAMI-DADE COUNTY APPROVED 3/16\"
2. FOR WOOD (G=0.55) APPLICATIONS IN MIAMI-DADE COUNTY, USE #10 STEEL SCREW, EMBEDDED 1 3/8\"
3. WOOD BUCKS DEPICTED IN THE SECTIONS ON THIS PAGE AS 1x ARE BUCKS WHOSE TOTAL THICKNESS IS LESS THAN 1 1/2\"
4. FOR ATTACHMENT TO ALUMINUM: THE MATERIAL SHALL BE A MINIMUM STRENGTH OF 6063-T5 AND A MINIMUM OF 1/8\"

Revised By:	Date:	Revisions:	
SC	08/01/15	D	INCLUDED MINIMUM SUBSTRATE REQUIREMENTS
Revised By:	Date:	Revisions:	
D.G.	12/18/08	B	NO CHANGE THIS SHEET
Revised By:	Date:	Revisions:	
JJ	10/07/11	C	NO CHANGE THIS SHEET
Drawn By:	Date:	Checked By:	Date:
D.G.	08/07/08		

1070 TECHNOLOGY DRIVE
N. VENICE, FL 34275

P.O. BOX 1529
N. VENICE, FL 34274
FL COA #29296



Description:			
ANCHORAGE DETAILS - BOX FRAME			
Title:			
Vinyl Single Hung Window, Large Missile Impact			
Series/Model:	Scale:	Sheet:	Drawing No.
SH500	NTS	10 of 11	5191-1
Rev:			D

PRODUCT REVISED
as complying with the Florida
Building Code
Acceptance No. 15-0612.12
Expiration Date April 11, 2018
By *Manuel Perez*
Miami Dade Product Control

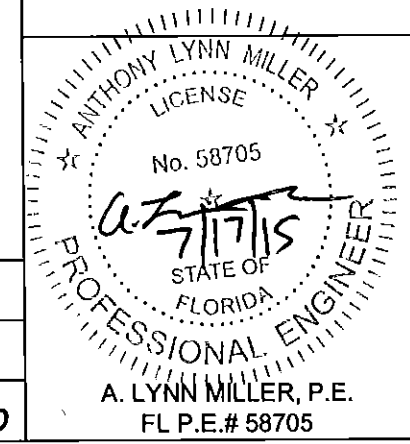

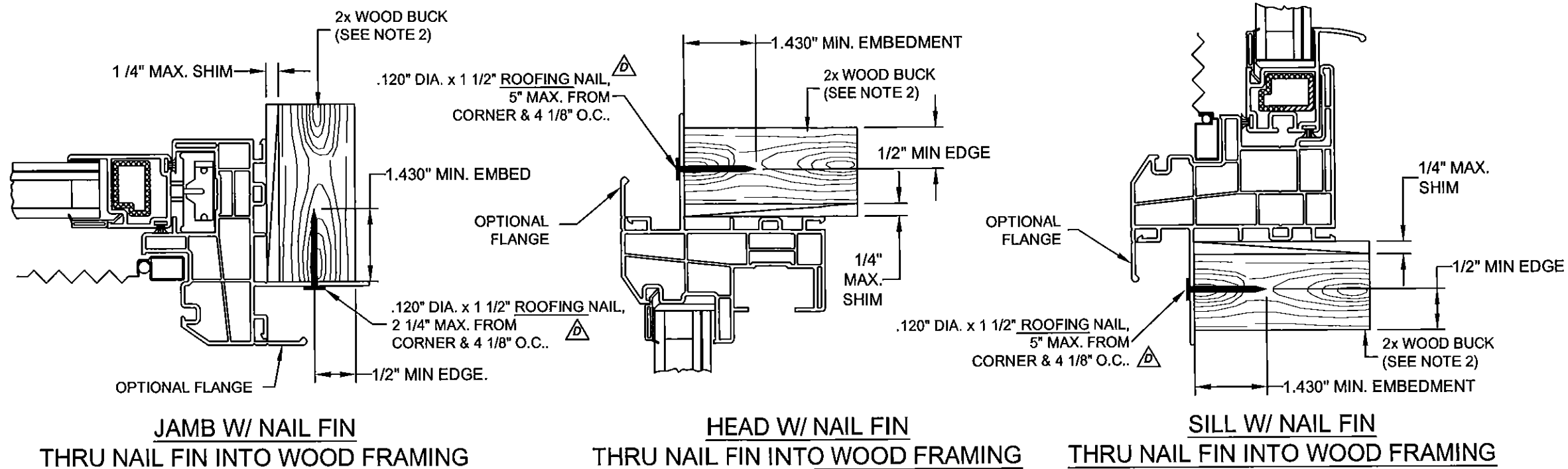

NOTES:

1. FOR INTEGRAL FIN APPLICATIONS IN MIAMI-DADE COUNTY, USE .120" DIA. x 1 1/2" ROOFING NAIL INTO WOOD (G=0.55)
2. WOOD BUCKS DEPICTED IN THE SECTIONS ON THIS PAGE AS 1x ARE BUCKS WHOSE TOTAL THICKNESS IS LESS THAN 1 1/2". 1x WOOD BUCKS ARE OPTIONAL IF UNIT CAN BE INSTALLED DIRECTLY TO SOLID CONCRETE. WOOD BUCKS DEPICTED AS 2x ARE 1 1/2" THICK OR GREATER. INSTALLATION TO THE SUBSTRATE OF WOOD BUCKS TO BE ENGINEERED BY OTHERS OR AS APPROVED BY AUTHORITY HAVING JURISDICTION.
3. FOR ATTACHMENT TO ALUMINUM: THE MATERIAL SHALL BE A MINIMUM STRENGTH OF 6063-T5 AND A MINIMUM OF 1/8" THICK. THE ALUMINUM STRUCTURAL MEMBER SHALL BE OF A SIZE TO PROVIDE FULL SUPPORT TO THE WINDOW FRAME SIMILAR TO THAT SHOWN IN THESE DETAILS FOR 2x WOOD BUCKS. THE ANCHOR SHALL BE A #10 SHEET METAL SCREW WITH FULL ENGAGEMENT INTO THE ALUMINUM. IF THESE CRITERIA ARE MET, THE RESPECTIVE DESIGN PRESSURES AND ANCHORAGE SPACING FOR ULTRACONS MAY BE USED.

Revised By:	Date:	Revisions:	
SC	06/01/16	D	CHANGED TO .120" X 1-1/2" ROOFING NAIL
Revised By:	Date:	Revisions:	
D.G.	12/18/08	B	NO CHANGE THIS SHEET
Revised By:	Date:	Revisions:	
JJ	10/07/11	C	NO CHANGE THIS SHEET
Drawn By:	Date:	Checked By:	Date:
D.G.	08/07/08		

1070 TECHNOLOGY DRIVE
N. VENICE, FL 34275

P.O. BOX 1529
N. VENICE, FL 34274
FL COA #29296



Description:	ANCHORAGE DETAILS - Integral Fin Frame			
Title:	Vinyl Single Hung Window, Large Missile Impact			
Series/Model:	SH500	Scale:	NTS	Sheet:
				11 of 11
Drawing No.	5191-1	Rev:	D	

PRODUCT REVISED
as complying with the Florida
Building Code
Acceptance No _____
Expiration Date _____

By _____
Miami Dade Product Control

